



## Licensing Sub-Committee

**Date:** Tuesday, 19 April 2022  
**Time:** 10.00 am  
**Venue:** Council Chamber, County Hall, Dorchester, DT1 1XJ

**Members (Quorum )**

Jon Andrews, Les Fry and Emma Parker

**Chief Executive:** Matt Prosser, County Hall, Dorchester, Dorset DT1 1XJ

For more information about this agenda please contact Democratic Services Meeting Contact 01305 224202 [elaine.tibble@dorsetcouncil.gov.uk](mailto:elaine.tibble@dorsetcouncil.gov.uk)

Members of the public are welcome to attend this meeting, apart from any items listed in the exempt part of this agenda.

For easy access to all the council's committee agendas and minutes download the free public app called Modern.Gov for use on any iPad, Android, and Windows tablet. Once downloaded select Dorset Council.

### Agenda

Item		Pages
1.	<b>ELECTION OF CHAIRMAN AND STATEMENT FOR THE PROCEDURE OF THE MEETING</b>	3 - 6
	To elect a Chairman for the meeting and the Chairman to present and explain the procedure for the meeting.	
2.	<b>APOLOGIES</b>	
	To receive any apologies for absence.	
3.	<b>DECLARATIONS OF INTEREST</b>	
	To disclose any pecuniary, other registrable or non-registrable interests as set out in the adopted Code of Conduct. In making their disclosure councillors are asked to state the agenda item, the nature of the interest and any action they propose to take as part of their declaration. If required, further advice should be sought from the Monitoring Officer in advance of the meeting.	

**4. URGENT ITEMS**

To consider any items of business which the Chairman has had prior notification and considers to be urgent pursuant to section 100B (4) b) of the Local Government Act 1972. The reason for the urgency shall be recorded in the minutes.

**5. NEW PREMISES LICENCE APPLICATION FOR TESCO,  
WEYMOUTH**

7 - 98

An application has been made for a new premises licence for Tesco in Weymouth. The application has been out to public consultation and has attracted relevant representations. A Licensing Sub-Committee must consider the application and representations at a public hearing.

**6. EXEMPT BUSINESS**

To move the exclusion of the press and the public for the following item in view of the likely disclosure of exempt information within the meaning of paragraph x of schedule 12 A to the Local Government Act 1972 (as amended).

The public and the press will be asked to leave the meeting whilst the item of business is considered.



## **THE LICENSING ACT 2003 (HEARINGS) REGULATIONS 2005**

### Rights of a Party

1. A party has the right to attend the hearing and may be represented by any person.
2. A party is entitled to give further information where the authority has asked for clarification.
3. A party can question another party, and/or address the authority, with consent of the authority.

### Failure to Attend

4. If the authority is informed a party does not wish to attend, the hearing may proceed in their absence.
5. If a party has not indicated their attendance and fails to attend the hearing may be adjourned if considered in the public interest, or hold the hearing ensuring the party's representation is considered.
6. Where the authority adjourns the hearing it shall notify the parties of the date, time and place.

### Procedural Information

7. At the start of the hearing, the authority shall explain the procedure which it proposes to follow and shall consider any request for permission for another person to appear at the hearing.
8. A hearing shall take the form of a discussion led by the authority and cross-examination shall not be permitted unless the authority considers that it is required.
9. The authority will allow the parties an equal maximum period of time in which to speak.
10. The authority may require any person behaving disruptively to leave, and may refuse that person to return, but such a person may, before the end of the hearing, submit in writing information they would have been entitled to give orally had they not been required to leave.

### **FOOTNOTE:**

In relation to all other matters governed by the Licensing Act 2003 (Hearings) Regulations 2005 any party or their representative may contact the Licensing Services at Dorset Council and they will be provided with a full copy of the regulations on request.

## LICENSING SUB-COMMITTEE PROCEDURE

1. At the start of the meeting the Chairman will introduce:
  - the members of the sub-committee
  - the council officers present
  - the parties and their representatives
2. The Chairman will then deal with any appropriate agenda items.
3. The Licensing Officer will be asked to outline the details of the application, including details of any withdrawn representations.
4. The applicant or their representative is then invited to present their case.
5. Committee members will be invited to ask questions.
6. Where appropriate the Responsible Bodies e.g. representatives of Police, Fire Services, Environmental Services or Trading Standards will be invited to address the sub-committee on any relevant representations they may have.
7. The Chairman may then allow an opportunity for questions.
8. The Chairman will ask any person who has made representations, who have already expressed a wish to do so, to address the sub-committee. The sub-committee will have read all the papers before them, including any letters of representation. Members of the public are asked to keep their comments concise and to the point.
9. All parties will be given the opportunity to “sum up” their case.
10. The Chairman will ask the Legal Advisor if all relevant points have been addressed before advising all parties present that the sub-committee will withdraw from the meeting to consider its decision in private. The sub-committee will be accompanied by the Democratic Services Officer and the Legal Advisor can be called upon to offer legal guidance.
11. On returning the Chairman will:
  - Notify all those present of the sub-committee’s decision (or indicate when it will be made)

- Give brief details of any conditions attached to the licence approval;
- Or
- Outline the reasons for the refusal
  - Inform that detailed reasons will follow in writing (unless given on the day)
  - Inform those present of their right to appeal to the Magistrates' Court

#### **NOTE**

The Chairman may vary this procedure, as circumstances require but will have regard to the rules of natural justice and the Licensing Act 2003 (Hearings) Regulations 2005.

The meeting will take place in public. However, the public can be excluded from all or part of the meeting where the sub-committee considers that the public interest in so doing outweighs the public interest in the meeting or that part of the meeting, taking place in public.

Under no circumstances must the parties or their witnesses offer the sub-committee information in the absence of the other parties.

The Chairman and the Sub-Committee have discretion whether to allow new information or documents to be submitted and read at the meeting.

This page is intentionally left blank

## Licensing Sub-Committee

19 April 2022

## New Premises Licence Application for Tesco, Weymouth

### For Decision

**Portfolio Holder:** Cllr L Miller, Customer and Community Services

**Local Councillor(s):** Cllr H Legg

**Executive Director:** J Sellgren, Executive Director of Place

Report Author: Roy Keepax  
Title: Senior Licensing Officer  
Tel: 01258 484031  
Email: roy.keepax@dorsetcouncil.gov.uk

**Report Status:** Public

**Brief Summary:** An application has been made for a new premises licence for Tesco in Weymouth. The application has been out to public consultation and has attracted relevant representations. A Licensing Sub-Committee must consider the application and representations at a public hearing.

**Recommendation:** The Sub-Committee determines the application in the light of written and oral evidence and resolves to take such steps as it considers appropriate and proportionate for the promotion of the licensing objectives of;

- a) The prevention of crime and disorder
- b) The prevention of public nuisance
- c) Public safety
- d) The protection of children from harm

**Reason for Recommendation:** The Sub-Committee must consider the oral representations and information given at the hearing before reaching a decision.

## 1. Background

1.1 Section 4 of the Licensing Act 2003 sets out the duties of the Licensing Authority, it sets out that a Council's licensing functions must be carried out with a view to promoting the four licensing objectives of:

- (a) the prevention of crime and disorder;
- (b) public safety;
- (c) the prevention of public nuisance; and
- (d) the protection of children from harm.

1.2 All applications and decisions are made with due regard to the [Licensing Act 2003](#) (the Act), the [Revised Guidance issued under Section 182 of the Licensing Act 2003](#) (the Guidance) and the [Dorset Council Statement of Licensing Policy](#) (the Policy).

1.3 The relationship between planning and licensing is set out in paragraphs 6.2 to 6.5 of the Dorset Council Policy: -

The use of premises for the sale or provision of alcohol, regulated entertainment or late-night refreshment is subject to planning control. Such use will require planning permission or must otherwise be lawful under planning legislation. Planning permission is generally required for the establishment of new premises or the change of use of premises.

In line with the S182 Guidance the planning and licensing regimes involve consideration of different (albeit related) matters. Licensing committees are not bound by decisions made by a planning committee, and vice versa.

Where businesses have indicated, when applying for a licence under the Act, that they have also applied for planning permission or that they intend to do so, licensing committees and officers will consider discussion with their planning counterparts prior to determination with the aim of agreeing mutually acceptable operating hours and scheme designs.

Where relevant representations are received, any decision on a licence application will not consider whether any decision to grant or refuse planning permission or building consent was lawful and correct. It will take into account what the impact of granting the application will be on the four licensing objectives.



## 2. **Details of the Application**

2.1 Tesco Stores Limited have applied for a premises licence at Tesco, 680 Dorchester Road, Weymouth, Dorset, DT3 5LD.

2.2 The description of the premises within the application form is: -

“Retail premises (supermarket) selling a range of goods and services. This includes the sale of alcohol for consumption off the premises. Sales of alcohol for consumption off the premises are made from the supermarket sales floor as shown on the enclosed plans”

2.3 The full application and the plans for the premises, as received, are attached at Appendix 1. The site location can be viewed on Appendix 3 taken from the Council’s Dorset Explorer page, showing the proximity of nearby residential properties.

2.4 The application is to permit: -

### **Late-night refreshment (Indoors)**

Everyday                      23:00 – 00:00

### **Off sales of alcohol**

Everyday                      06:00 – 00:00

## 3. **Representations from Responsible Authorities**

3.1. Section 13 of the Licensing Act 2003 contains the list of Responsible Authorities who must be consulted on each premises application. Dorset Police, Dorset and Wiltshire Fire Service, Public Health Dorset, the Immigration Authority, Dorset Council Trading Standards, Dorset Council Planning Department, Dorset Council Children’s Services and Dorset Council Health and Safety Team have all been consulted and offered no representations or comments on this application.

#### 4. **Representations from Other Persons**

4.1. 51 representations have been received from members of the public. All the representations are expressing objections to the application, and these are included, in full, at Appendix 2 (page 97). Most of the representations received made comment on the need for this kind of store in the area, anti-social behaviour linked to the sale of alcohol, parking concerns and noise that would emanate from the increase of traffic. The concerns of need, parking or increased traffic would have been concerns for the planning process. They would have been taken into consideration during the premises planning application which the planning authority granted. The matters concerning anti-social behaviour must be taken into consideration under the procedures as set out in the Licensing Act 2003.

4.2. The Guidance sets out at 8.13 the role of “other persons”: -

“As well as responsible authorities, any other person can play a role in a number of licensing processes under the 2003 Act. This includes any individual, body or business entitled to make representations to licensing authorities in relation to applications for the grant, variation, minor variation or review of premises licences and club premises certificates, regardless of their geographic proximity to the premises. In addition, these persons may themselves seek a review of a premises licence. Any representations made by these persons must be ‘relevant’, in that the representation relates to one or more of the licensing objectives. It must also not be considered by the licensing authority to be frivolous or vexatious. In the case of applications for reviews, there is an additional requirement that the grounds for the review should not be considered by the licensing authority to be repetitious. Chapter 9 of this guidance (paragraphs 9.4 to 9.10) provides more detail on the definition of relevant, frivolous and vexatious representations.

4.3. The guidance states at paragraph 9.4 what a “relevant” representation is;  
-

“A representation is “relevant” if it relates to the likely effect of the grant of the licence on the promotion of at least one of the licensing objectives. For example, a representation from a local businessperson about the commercial damage caused by competition from new licensed premises would not be relevant. On

the other hand, a representation by a businessperson that nuisance caused by new premises would deter customers from entering the local area, and the steps proposed by the applicant to prevent that nuisance were inadequate, would be relevant. In other words, representations should relate to the impact of licensable activities carried on from premises on the objectives.”

## 5. Considerations

- 5.1 Paragraphs 9.42 to 9.44 of the Section 182 Guidance sets how the Authority should decide what actions are appropriate.

“9.42 Licensing authorities are best placed to determine what actions are appropriate for the promotion of the licensing objectives in their areas. All licensing determinations should be considered on a case by-case basis. They should take into account any representations or objections that have been received from responsible authorities or other persons, and representations made by the applicant or premises user as the case may be.

9.43 The authority’s determination should be evidence-based, justified as being appropriate for the promotion of the licensing objectives and proportionate to what it is intended to achieve.

9.44 Determination of whether an action or step is appropriate for the promotion of the licensing objectives requires an assessment of what action or step would be suitable to achieve that end. While this does not therefore require a licensing authority to decide that no lesser step will achieve the aim, the authority should aim to consider the potential burden that the condition would impose on the premises licence holder (such as the financial burden due to restrictions on licensable activities) as well as the potential benefit in terms of the promotion of the licensing objectives. However, it is imperative that the authority ensures that the factors which form the basis of its determination are limited to consideration of the promotion of the objectives and nothing outside those parameters. As with the consideration of licence variations, the licensing authority should consider wider issues such as other conditions already in place to mitigate potential negative impact on the promotion of the licensing objectives and the track record of the business. Further advice on determining what is appropriate when imposing conditions on a licence or certificate is provided in Chapter 10. The licensing authority is expected to come to its determination based on an assessment of the evidence on both the risks and benefits either for or against making the determination.”

6. **Financial Implications**

Any decision of the Sub-Committee could lead to an appeal by any of the parties involved that could incur costs.

7. **Climate Implications**

None

8. **Well-being and Health Implications**

None

9. **Other Implications**

Public Health and Community Safety

10. **Risk Assessment**

10.1 **HAVING CONSIDERED:** the risks associated with this decision; the level of risk has been identified as:

Current Risk: Low

Residual Risk: Low

11. **Equalities Impact Assessment**

None

12. **Appendices**

- Appendix 1 – Application and plan
- Appendix 2 – Representations from ‘other persons’
- Appendix 3 – Site Location

13. **Background Papers**

[Licensing Act](#)

[Section 182 Guidance](#)

[Dorset Council Licensing Policy](#)

This page is intentionally left blank

## Application for a premises licence to be granted under the Licensing Act 2003

### PLEASE READ THE FOLLOWING INSTRUCTIONS FIRST

Before completing this form please read the guidance notes at the end of the form. If you are completing this form by hand please write legibly in block capitals. In all cases ensure that your answers are inside the boxes and written in black ink. Use additional sheets if necessary.

You may wish to keep a copy of the completed form for your records.

~~I/We~~ Tesco Stores Limited

*(Insert name(s) of applicant)*

**apply for a premises licence under section 17 of the Licensing Act 2003 for the premises described in Part 1 below (the premises) and I/we are making this application to you as the relevant licensing authority in accordance with section 12 of the Licensing Act 2003**

#### Part 1 – Premises details

Postal address of premises or, if none, ordnance survey map reference or description			
680, Dorchester Road, Weymouth, Dorset, DT3 5LD			
<b>Post town</b>	Weymouth, Dorset	<b>Postcode</b>	DT3 5LD

Telephone number at premises (if any)	<b>01707 940740</b>
Non-domestic rateable value of premises	<b>£20,750.00</b> <b><a href="https://www.tax.service.gov.uk/business-rates-find/valuations/23842796000">https://www.tax.service.gov.uk/business-rates-find/valuations/23842796000</a></b>

#### Part 2 - Applicant details

Please state whether you are applying for a premises licence as **Please tick as appropriate**

- a) an individual or individuals \*  please complete section (A)
- b) a person other than an individual \*
- i as a limited company/limited liability partnership  please complete section (B)
- ii as a partnership (other than limited liability)  please complete section (B)
- iii as an unincorporated association or  please complete section (B)
- iv other (for example a statutory corporation)  please complete section (B)
- c) a recognised club  please complete section (B)
- d) a charity  please complete section (B)
- e) the proprietor of an educational establishment  please complete section (B)

- f) a health service body  please complete section (B)
- g) a person who is registered under Part 2 of the Care Standards Act 2000 (c14) in respect of an independent hospital in Wales  please complete section (B)
- ga) a person who is registered under Chapter 2 of Part 1 of the Health and Social Care Act 2008 (within the meaning of that Part) in an independent hospital in England  please complete section (B)
- h) the chief officer of police of a police force in England and Wales  please complete section (B)

\* If you are applying as a person described in (a) or (b) please confirm (by ticking yes to one box below):

- I am carrying on or proposing to carry on a business which involves the use of the premises for licensable activities; or
- I am making the application pursuant to a
- statutory function or
- a function discharged by virtue of Her Majesty's prerogative

**(A) INDIVIDUAL APPLICANTS** (fill in as applicable)

Mr <input type="checkbox"/>	Mrs <input type="checkbox"/>	Miss <input type="checkbox"/>	Ms <input type="checkbox"/>	Other Title (for example, Rev)	
<b>Surname</b>			<b>First names</b>		
<b>Date of birth</b>		I am 18 years old or over <input type="checkbox"/>		Please tick yes	
<b>Nationality</b>					
Current residential address if different from premises address					
Post town				Postcode	
<b>Daytime contact telephone number</b>					
<b>E-mail address (optional)</b>					
Where applicable (if demonstrating a right to work via the Home Office online right to work checking service), the 9-digit 'share code' provided to the applicant by that service (please see note 15 for information)					

**SECOND INDIVIDUAL APPLICANT** (if applicable)



Mr <input type="checkbox"/>	Mrs <input type="checkbox"/>	Miss <input type="checkbox"/>	Ms <input type="checkbox"/>	Other Title (for example, Rev)	
<b>Surname</b>			<b>First names</b>		
<b>Date of birth</b>			I am 18 years old or over <input type="checkbox"/> Please tick yes		
<b>Nationality</b>					
Where applicable (if demonstrating a right to work via the Home Office online right to work checking service), the 9-digit 'share code' provided to the applicant by that service: (please see note 15 for information)					
Current residential address if different from premises address					
Post town				Postcode	
<b>Daytime contact telephone number</b>					
<b>E-mail address (optional)</b>					

**(B) OTHER APPLICANTS**

**Please provide name and registered address of applicant in full. Where appropriate please give any registered number. In the case of a partnership or other joint venture (other than a body corporate), please give the name and address of each party concerned.**

<b>Name</b> Tesco Stores Limited
<b>Address</b>  Tesco House Shire Park Kestrel Way Welwyn Garden City Hertfordshire AL7 1GA
<b>Registered number (where applicable)</b>  00519500
<b>Description of applicant (for example, partnership, company, unincorporated association etc.)</b>  Private Limited Company

Telephone number (if any)

01707 940740

E-mail address (optional)

Licensing.Team@tesco.com

### Part 3 Operating Schedule

When do you want the premises licence to start?

DD	MM	YYYY
<input type="text"/>	<input type="text"/>	<input type="text"/>

If you wish the licence to be valid only for a limited period, when do you want it to end?

DD	MM	YYYY
<input type="text"/>	<input type="text"/>	<input type="text"/>

Please give a general description of the premises (please read guidance note 1)

Retail premises (supermarket) selling a range of goods and services. This includes the sale of alcohol for consumption off the premises. Sales of alcohol for consumption off the premises are made from the supermarket sales floor as shown on the enclosed plan.

If 5,000 or more people are expected to attend the premises at any one time, please state the number expected to attend.

N/A

What licensable activities do you intend to carry on from the premises?

(please see sections 1 and 14 and Schedules 1 and 2 to the Licensing Act 2003)

Provision of regulated entertainment (please read guidance note 2)

Please tick all that apply

- a) plays (if ticking yes, fill in box A)
- b) films (if ticking yes, fill in box B)
- c) indoor sporting events (if ticking yes, fill in box C)
- d) boxing or wrestling entertainment (if ticking yes, fill in box D)
- e) live music (if ticking yes, fill in box E)
- f) recorded music (if ticking yes, fill in box F)
- g) performances of dance (if ticking yes, fill in box G)
- h) anything of a similar description to that falling within (e), (f) or (g) (if ticking yes, fill in box H)

**Provision of late night refreshment** (if ticking yes, fill in box I)

**Supply of alcohol** (if ticking yes, fill in box J)

In all cases complete boxes K, L and M

**A**

<b>Plays</b> Standard days and timings (please read guidance note 7)			<b><u>Will the performance of a play take place indoors or outdoors or both – please tick</u></b> (please read guidance note 3)	Indoors	<input type="checkbox"/>
				Outdoors	<input type="checkbox"/>
				Both	<input type="checkbox"/>
Day	Start	Finish			
Mon			<b><u>Please give further details here</u></b> (please read guidance note 4)		
Tue					
Wed			<b><u>State any seasonal variations for performing plays</u></b> (please read guidance note 5)		
Thur					
Fri			<b><u>Non standard timings. Where you intend to use the premises for the performance of plays at different times to those listed in the column on the left, please list</u></b> (please read guidance note 6)		
Sat					
Sun					

## B

<b>Films</b> Standard days and timings (please read guidance note 7)			<b><u>Will the exhibition of films take place indoors or outdoors or both – please tick</u></b> (please read guidance note 3)	Indoors	<input type="checkbox"/>
				Outdoors	<input type="checkbox"/>
				Both	<input type="checkbox"/>
Day	Start	Finish	<b><u>Please give further details here</u></b> (please read guidance note 4)		
Mon					
Tue			<b><u>State any seasonal variations for the exhibition of films</u></b> (please read guidance note 5)		
Wed					
Thur			<b><u>Non standard timings. Where you intend to use the premises for the exhibition of films at different times to those listed in the column on the left, please list</u></b> (please read guidance note 6)		
Fri					
Sat					
Sun					

**C**

<b>Indoor sporting events</b> Standard days and timings (please read guidance note 7)			<b><u>Please give further details</u></b> (please read guidance note 4)
Day	Start	Finish	
Mon			<b><u>State any seasonal variations for indoor sporting events</u></b> (please read guidance note 5)
Tue			
Wed			
Thur			<b><u>Non standard timings. Where you intend to use the premises for indoor sporting events at different times to those listed in the column on the left, please list</u></b> (please read guidance note 6)
Fri			
Sat			
Sun			

**D**

<b>Boxing or wrestling entertainments</b> Standard days and timings (please read guidance note 7)			<b><u>Will the boxing or wrestling entertainment take place indoors or outdoors or both – please tick</u></b> (please read guidance note 3)	Indoors	<input type="checkbox"/>
				Outdoors	<input type="checkbox"/>
				Both	<input type="checkbox"/>
Day	Start	Finish			
Mon			<b><u>Please give further details here</u></b> (please read guidance note 4)		
Tue					
Wed			<b><u>State any seasonal variations for boxing or wrestling entertainment</u></b> (please read guidance note 5)		
Thur					
Fri			<b><u>Non standard timings. Where you intend to use the premises for boxing or wrestling entertainment at different times to those listed in the column on the left, please list</u></b> (please read guidance note 6)		
Sat					
Sun					

**E**

<b>Live music</b> Standard days and timings (please read guidance note 7)			<b><u>Will the performance of live music take place indoors or outdoors or both – please tick</u></b> (please read guidance note 3)	Indoors	<input type="checkbox"/>
				Outdoors	<input type="checkbox"/>
				Both	<input type="checkbox"/>
Day	Start	Finish	<b><u>Please give further details here</u></b> (please read guidance note 4)		
Mon					
			<b><u>State any seasonal variations for the performance of live music</u></b> (please read guidance note 5)		
Tue					
			<b><u>Non standard timings. Where you intend to use the premises for the performance of live music at different times to those listed in the column on the left, please list</u></b> (please read guidance note 6)		
Wed					
Thur					
Fri					
Sat					
Sun					

**F**

<b>Recorded music</b> Standard days and timings (please read guidance note 7)			<b><u>Will the playing of recorded music take place indoors or outdoors or both – please tick</u></b> (please read guidance note 3)	Indoors	<input type="checkbox"/>
				Outdoors	<input type="checkbox"/>
				Both	<input type="checkbox"/>
Day	Start	Finish			
Mon			<b><u>Please give further details here</u></b> (please read guidance note 4)		
Tue			<b><u>Please give further details here</u></b> (please read guidance note 4)		
Wed			<b><u>State any seasonal variations for the playing of recorded music</u></b> (please read guidance note 5)		
Thur			<b><u>State any seasonal variations for the playing of recorded music</u></b> (please read guidance note 5)		
Fri			<b><u>Non standard timings. Where you intend to use the premises for the playing of recorded music at different times to those listed in the column on the left, please list</u></b> (please read guidance note 6)		
Sat					
Sun					



# G

Performances of dance Standard days and timings (please read guidance note 7)			<b><u>Will the performance of dance take place indoors or outdoors or both – please tick</u></b> (please read guidance note 3)	Indoors	<input type="checkbox"/>
Day	Start	Finish		Outdoors	<input type="checkbox"/>
				Both	<input type="checkbox"/>
Mon			<b><u>Please give further details here</u></b> (please read guidance note 4)		
Tue			<b><u>Please give further details here</u></b> (please read guidance note 4)		
Wed			<b><u>State any seasonal variations for the performance of dance</u></b> (please read guidance note 5)		
Thur			<b><u>State any seasonal variations for the performance of dance</u></b> (please read guidance note 5)		
Fri			<b><u>Non standard timings. Where you intend to use the premises for the performance of dance at different times to those listed in the column on the left, please list</u></b> (please read guidance note 6)		
Sat			<b><u>Non standard timings. Where you intend to use the premises for the performance of dance at different times to those listed in the column on the left, please list</u></b> (please read guidance note 6)		
Sun			<b><u>Non standard timings. Where you intend to use the premises for the performance of dance at different times to those listed in the column on the left, please list</u></b> (please read guidance note 6)		

# H

<b>Anything of a similar description to that falling within (e), (f) or (g)</b> Standard days and timings (please read guidance note 7)			Please give a description of the type of entertainment you will be providing		
Day	Start	Finish	<b><u>Will this entertainment take place indoors or outdoors or both – please tick</u></b> (please read guidance note 3)	Indoors	<input type="checkbox"/>
Mon				Outdoors	<input type="checkbox"/>
				Both	<input type="checkbox"/>
Tue			<b><u>Please give further details here</u></b> (please read guidance note 4)		
Wed					
Thur			<b><u>State any seasonal variations for entertainment of a similar description to that falling within (e), (f) or (g)</u></b> (please read guidance note 5)		
Fri					
Sat			<b><u>Nonstandard timings. Where you intend to use the premises for the entertainment of a similar description to that falling within (e), (f) or (g) at different times to those listed in the column on the left, please list</u></b> (please read guidance note 6)		
Sun					

**I**

<b>Late-night refreshment</b> Standard days and timings (please read guidance note 7)			<b>Will the provision of late night refreshment take place indoors or outdoors or both – please tick</b> (please read guidance note 3)	Indoors	<input checked="" type="checkbox"/>																							
				Outdoors	<input type="checkbox"/>																							
<table border="1"> <thead> <tr> <th>Day</th> <th>Start</th> <th>Finish</th> </tr> </thead> <tbody> <tr> <td>Mon</td> <td>23:00</td> <td>00:00</td> </tr> <tr> <td>Tue</td> <td>23:00</td> <td>00:00</td> </tr> <tr> <td>Wed</td> <td>23:00</td> <td>00:00</td> </tr> <tr> <td>Thur</td> <td>23:00</td> <td>00:00</td> </tr> <tr> <td>Fri</td> <td>23:00</td> <td>00:00</td> </tr> <tr> <td>Sat</td> <td>23:00</td> <td>00:00</td> </tr> <tr> <td>Sun</td> <td>23:00</td> <td>00:00</td> </tr> </tbody> </table>				Day	Start	Finish	Mon	23:00	00:00	Tue	23:00	00:00	Wed	23:00	00:00	Thur	23:00	00:00	Fri	23:00	00:00	Sat	23:00	00:00	Sun	23:00	00:00	Both
Day	Start	Finish																										
Mon	23:00	00:00																										
Tue	23:00	00:00																										
Wed	23:00	00:00																										
Thur	23:00	00:00																										
Fri	23:00	00:00																										
Sat	23:00	00:00																										
Sun	23:00	00:00																										
			<b><u>Please give further details here</u></b> (please read guidance note 4)																									
			<b><u>State any seasonal variations for the provision of late-night refreshment</u></b> (please read guidance note 5)																									
			<b><u>Non-standard timings. Where you intend to use the premises for the provision of late night refreshment at different times, to those listed in the column on the left, please list</u></b> (please read guidance note 6)																									

**J**

<b>Supply of alcohol</b> Standard days and timings (please read guidance note 7)			<b>Will the supply of alcohol be for consumption – please tick</b> (please read guidance note 8)	On the premises	<input type="checkbox"/>
				Off the premises	<input checked="" type="checkbox"/>
				Both	<input type="checkbox"/>
<b>Day</b>	<b>Start</b>	<b>Finish</b>	<b>State any seasonal variations for the supply of alcohol</b> (please read guidance note 5)		
Mon	06:00	00:00			
Tue	06:00	00:00			
Wed	06:00	00:00			
Thur	06:00	00:00			
Fri	06:00	00:00			
Sat	06:00	00:00			
Sun	06:00	00:00			

**State the name and details of the individual whom you wish to specify on the licence as designated premises supervisor (Please see declaration about the entitlement to work in the checklist at the end of the form):**

<b>Name</b> Mr. Steven Nicholas Andrzejuk	
<b>Date of birth</b> ██████████	
<b>Address</b> ██████████	
<b>Postcode</b>	██████████
<b>Personal licence number (if known)</b> NHPER/1869	
<b>Issuing licensing authority (if known)</b> North Herts District Council	



## M

Describe the steps you intend to take to promote the four licensing objectives:

**a) General – all four licensing objectives (b, c, d and e) (please read guidance note 10)**

Tesco is a large national operator with a range of head office and local support. The company has devised policies, procedures, systems and training to ensure that they sell alcohol in a responsible manner.

There is a detailed programme which ensures that comprehensive training is provided to employees having regard to their role and the responsibilities and such training is regularly reviewed, and records kept.

**b) The prevention of crime and disorder**

We will have a digital CCTV system that covers the premises, including the main area which will be used for display of alcohol. Images will be retained for 31 days.

A member of the management team will be on the premises all the times the store is open. This colleague will have responsibility for the premises and will be the initial point of contact for any issues that may arise.

**c) Public safety**

The premises licence holder is fully aware of its responsibilities under a range of health and safety related legislation and has policies and procedures in place to be confident of complying with the relevant obligations which arise.

**d) The prevention of public nuisance**

The company has a “good neighbour” ethos which seeks to ensure that the premises plays an active part in the local community.

**e) The protection of children from harm**

The premises will operate a Think 25 policy. The checkouts will be programmed to prompt the customer assistant when an alcohol product is scanned at the checkout to follow the Think 25 policy.

All colleagues will receive training in relation to the underlying law and Tesco policy, systems, and procedures. This training will be documented, and refresher training will be provided on a regular basis.

**Checklist:**

**Please tick to indicate agreement**

- I have made or enclosed payment of the fee.
- I have enclosed the plan of the premises.
- I have sent copies of this application and the plan to responsible authorities and others where applicable.
- I have enclosed the consent form completed by the individual I wish to be designated premises supervisor, if applicable.
- I understand that I must now advertise my application.
- I understand that if I do not comply with the above requirements my application will be rejected.
- [Applicable to all individual applicants, including those in a partnership which is not a limited liability partnership, but not companies or limited liability partnerships] I have included documents demonstrating my entitlement to work in the United Kingdom or my share code issued by the Home Office online right to work checking service (please read note 15).

**IT IS AN OFFENCE, UNDER SECTION 158 OF THE LICENSING ACT 2003, TO MAKE A FALSE STATEMENT IN OR IN CONNECTION WITH THIS APPLICATION. THOSE WHO MAKE A FALSE STATEMENT MAY BE LIABLE ON SUMMARY CONVICTION TO A FINE OF ANY AMOUNT.**

**IT IS AN OFFENCE UNDER SECTION 24B OF THE IMMIGRATION ACT 1971 FOR A PERSON TO WORK WHEN THEY KNOW, OR HAVE REASONABLE CAUSE TO BELIEVE, THAT THEY ARE DISQUALIFIED FROM DOING SO BY REASON OF THEIR IMMIGRATION STATUS. THOSE WHO EMPLOY AN ADULT WITHOUT LEAVE OR WHO IS SUBJECT TO CONDITIONS AS TO EMPLOYMENT WILL BE LIABLE TO A CIVIL PENALTY UNDER SECTION 15 OF THE IMMIGRATION, ASYLUM AND NATIONALITY ACT 2006 AND PURSUANT TO SECTION 21 OF THE SAME ACT, WILL BE COMMITTING AN OFFENCE WHERE THEY DO SO IN THE KNOWLEDGE, OR WITH REASONABLE CAUSE TO BELIEVE, THAT THE EMPLOYEE IS DISQUALIFIED.**

**Part 4 – Signatures** (please read guidance note 11)

**Signature of applicant or applicant’s solicitor or other duly authorised agent** (see guidance note 12). **If signing on behalf of the applicant, please state in what capacity.**

<b>Declaration</b>	<ul style="list-style-type: none"><li>• [Applicable to individual applicants only, including those in a partnership which is not a limited liability partnership] I understand I am not entitled to be issued with a licence if I do not have the entitlement to live and work in the UK (or if I am subject to a condition preventing me from doing work relating to the carrying on of a licensable activity) and that my licence will become invalid if I cease to be entitled to live and work in the UK (please read guidance note 15).</li><li>• The DPS named in this application form is entitled to work in the UK (and is not subject to conditions preventing him or her from doing work relating to a licensable activity) and I have seen a copy of his or</li></ul>
--------------------	---

	her proof of entitlement to work, or have conducted an online right to work check using the Home Office online right to work checking service which confirmed their right to work (please see note 15)
Signature	
Date	25/02/2022
Capacity	Hardish Purewal – Licensing Manager

**For joint applications, signature of 2<sup>nd</sup> applicant or 2<sup>nd</sup> applicant’s solicitor or other authorised agent** (please read guidance note 13). **If signing on behalf of the applicant, please state in what capacity.**

Signature	
Date	
Capacity	

Contact name (where not previously given) and postal address for correspondence associated with this application (please read guidance note 14)			
<b>Tesco Licensing Team, 5 Falcon Way (Maldon), Shire Park</b>			
Post town	<b>Welwyn Garden City</b>	Postcode	<b>AL7 1TW</b>
Telephone number (if any)	01707 940740		
If you would prefer us to correspond with you by e-mail, your e-mail address (optional) <b>Licensing.Team@tesco.com</b>			



## Notes for Guidance

1. Describe the premises, for example the type of premises, its general situation and layout and any other information which could be relevant to the licensing objectives. Where your application includes off-supplies of alcohol and you intend to provide a place for consumption of these off-supplies, you must include a description of where the place will be and its proximity to the premises.
2. In terms of specific regulated entertainments please note that:
  - Plays: no licence is required for performances between 08:00 and 23.00 on any day, provided that the audience does not exceed 500.
  - Films: no licence is required for 'not-for-profit' film exhibition held in community premises between 08.00 and 23.00 on any day provided that the audience does not exceed 500 and the organiser (a) gets consent to the screening from a person who is responsible for the premises; and (b) ensures that each such screening abides by age classification ratings.
  - Indoor sporting events: no licence is required for performances between 08.00 and 23.00 on any day, provided that the audience does not exceed 1000.
  - Boxing or Wrestling Entertainment: no licence is required for a contest, exhibition or display of Greco-Roman wrestling, or freestyle wrestling between 08.00 and 23.00 on any day, provided that the audience does not exceed 1000. Combined fighting sports – defined as a contest, exhibition or display which combines boxing or wrestling with one or more martial arts – are licensable as a boxing or wrestling entertainment rather than an indoor sporting event.
  - Live music: no licence permission is required for:
    - a performance of unamplified live music between 08.00 and 23.00 on any day, on any premises.
    - a performance of amplified live music between 08.00 and 23.00 on any day on premises authorised to sell alcohol for consumption on those premises, provided that the audience does not exceed 500.
    - a performance of amplified live music between 08.00 and 23.00 on any day, in a workplace that is not licensed to sell alcohol on those premises, provided that the audience does not exceed 500.
    - a performance of amplified live music between 08.00 and 23.00 on any day, in a church hall, village hall, community hall, or other similar community premises, that is not licensed by a premises licence to sell alcohol, provided that (a) the audience does not exceed 500, and (b) the organiser gets consent for the performance from a person who is responsible for the premises.
    - a performance of amplified live music between 08.00 and 23.00 on any day, at the non-residential premises of (i) a local authority, or (ii) a school, or (iii) a hospital, provided that (a) the audience does not exceed 500, and (b) the organiser gets consent for the performance on the relevant premises from: (i) the local authority concerned, or (ii) the school or (iii) the health care provider for the hospital.
  - Recorded Music: no licence permission is required for:
    - any playing of recorded music between 08.00 and 23.00 on any day on premises authorised to sell alcohol for consumption on those premises, provided that the audience does not exceed 500.
    - any playing of recorded music between 08.00 and 23.00 on any day, in a church hall, village hall, community hall, or other similar community premises, that is not licensed by a premises licence to sell alcohol, provided that (a) the audience does not exceed 500, and (b) the organiser gets consent for the performance from a person who is responsible for the premises.

- any playing of recorded music between 08.00 and 23.00 on any day, at the non-residential premises of (i) a local authority, or (ii) a school, or (iii) a hospital, provided that (a) the audience does not exceed 500, and (b) the organiser gets consent for the performance on the relevant premises from: (i) the local authority concerned, or (ii) the school proprietor or (iii) the health care provider for the hospital.
  - Dance: no licence is required for performances between 08.00 and 23.00 on any day, provided that the audience does not exceed 500. However, a performance which amounts to adult entertainment remains licensable.
  - Cross activity exemptions: no licence is required between 08.00 and 23.00 on any day, with no limit on audience size for:
    - any entertainment taking place on the premises of the local authority where the entertainment is provided by or on behalf of the local authority;
    - any entertainment taking place on the hospital premises of the health care provider where the entertainment is provided by or on behalf of the health care provider;
    - any entertainment taking place on the premises of the school where the entertainment is provided by or on behalf of the school proprietor; and
    - any entertainment (excluding films and a boxing or wrestling entertainment) taking place at a travelling circus, provided that (a) it takes place within a moveable structure that accommodates the audience, and (b) that the travelling circus has not been located on the same site for more than 28 consecutive days.
3. Where taking place in a building or other structure please tick as appropriate (indoors may include a tent).
  4. For example the type of activity to be authorised, if not already stated, and give relevant further details, for example (but not exclusively) whether or not music will be amplified or unamplified.
  5. For example (but not exclusively), where the activity will occur on additional days during the summer months.
  6. For example (but not exclusively), where you wish the activity to go on longer on a particular day e.g. Christmas Eve.
  7. Please give timings in 24 hour clock (e.g. 16.00) and only give details for the days of the week when you intend the premises to be used for the activity.
  8. If you wish people to be able to consume alcohol on the premises, please tick 'on the premises'. If you wish people to be able to purchase alcohol to consume away from the premises, please tick 'off the premises'. If you wish people to be able to do both, please tick 'both'.
  9. Please give information about anything intended to occur at the premises or ancillary to the use of the premises which may give rise to concern in respect of children, regardless of whether you intend children to have access to the premises, for example (but not exclusively) nudity or semi-nudity, films for restricted age groups or the presence of gaming machines.
  10. Please list here steps you will take to promote all four licensing objectives together.
  11. The application form must be signed.
  12. An applicant's agent (for example solicitor) may sign the form on their behalf provided that they have actual authority to do so.
  13. Where there is more than one applicant, each of the applicants or their respective agent must sign the application form.
  14. This is the address which we shall use to correspond with you about this application.
- 15. Entitlement to work/immigration status for individual applicants and applications from partnerships which are not limited liability partnerships:**

A licence may not be held by an individual or an individual in a partnership who is resident in the UK who:

- does not have the right to live and work in the UK; or
- is subject to a condition preventing him or her from doing work relating to the carrying on of a licensable activity.

Any premises licence issued in respect of an application made on or after 6 April 2017 will become invalid if the holder ceases to be entitled to work in the UK.

Applicants must demonstrate that they have an entitlement to work in the UK and are not subject to a condition preventing them from doing work relating to the carrying on of a licensable activity. They do this in one of two ways: 1) by providing with this application copies or scanned copies of the documents listed below (which do not need to be certified), or 2) by providing their 'share code' to enable the licensing authority to carry out a check using the Home Office online right to work checking service (see below).

### **Documents which demonstrate entitlement to work in the UK**

- An expired or current passport showing the holder, or a person named in the passport as the child of the holder, is a British citizen or a citizen of the UK and Colonies having the right of abode in the UK [please see note below about which sections of the passport to copy].
- An expired or current passport or national identity card showing the holder, or a person named in the passport as the child of the holder, is a national of a European Economic Area country or Switzerland.
- A Registration Certificate or document certifying permanent residence issued by the Home Office to a national of a European Economic Area country or Switzerland.
- A Permanent Residence Card issued by the Home Office to the family member of a national of a European Economic Area country or Switzerland.
- A **current** Biometric Immigration Document (Biometric Residence Permit) issued by the Home Office to the holder indicating that the person named is allowed to stay indefinitely in the UK, or has no time limit on their stay in the UK.
- A **current** passport endorsed to show that the holder is exempt from immigration control, is allowed to stay indefinitely in the UK, has the right of abode in the UK, or has no time limit on their stay in the UK.
- A **current** Immigration Status Document issued by the Home Office to the holder with an endorsement indicating that the named person is allowed to stay indefinitely in the UK or has no time limit on their stay in the UK, **when produced in combination with** an official document giving the person's permanent National Insurance number and their name issued by a Government agency or a previous employer.
- A birth or adoption certificate issued in the UK, **when produced in combination with** an official document giving the person's permanent National Insurance number and their name issued by a Government agency or a previous employer.
- A birth or adoption certificate issued in the Channel Islands, the Isle of Man or Ireland **when produced in combination with** an official document giving the

person's permanent National Insurance number and their name issued by a Government agency or a previous employer.

- A certificate of registration or naturalisation as a British citizen, **when produced in combination with** an official document giving the person's permanent National Insurance number and their name issued by a Government agency or a previous employer.
- A **current** passport endorsed to show that the holder is allowed to stay in the UK and is currently allowed to work and is not subject to a condition preventing the holder from doing work relating to the carrying on of a licensable activity.
- A **current** Biometric Immigration Document (Biometric Residence Permit) issued by the Home Office to the holder which indicates that the named person can currently stay in the UK and is allowed to work relation to the carrying on of a licensable activity.
- A **current** Residence Card issued by the Home Office to a person who is not a national of a European Economic Area state or Switzerland but who is a family member of such a national or who has derivative rights or residence.
- A **current** Immigration Status Document containing a photograph issued by the Home Office to the holder with an endorsement indicating that the named person may stay in the UK, and is allowed to work and is not subject to a condition preventing the holder from doing work relating to the carrying on of a licensable activity **when produced in combination with** an official document giving the person's permanent National Insurance number and their name issued by a Government agency or a previous employer.
- A Certificate of Application, **less than 6 months old**, issued by the Home Office under regulation 18(3) or 20(2) of the Immigration (European Economic Area) Regulations 2016, to a person who is not a national of a European Economic Area state or Switzerland but who is a family member of such a national or who has derivative rights of residence.
- Reasonable evidence that the person has an outstanding application to vary their permission to be in the UK with the Home Office such as the Home Office acknowledgement letter or proof of postage evidence, or reasonable evidence that the person has an appeal or administrative review pending on an immigration decision, such as an appeal or administrative review reference number.
- Reasonable evidence that a person who is not a national of a European Economic Area state or Switzerland but who is a family member of such a national or who has derivative rights of residence in exercising treaty rights in the UK including:
  - evidence of the applicant's own identity – such as a passport,
  - evidence of their relationship with the European Economic Area family member – e.g. a marriage certificate, civil partnership certificate or birth certificate, and
  - evidence that the European Economic Area national has a right of permanent residence in the UK or is one of the following if they have been in the UK for more than 3 months:

- (i) working e.g. employment contract, wage slips, letter from the employer,
- (ii) self-employed e.g. contracts, invoices, or audited accounts with a bank,
- (iii) studying e.g. letter from the school, college or university and evidence of sufficient funds; or
- (iv) self-sufficient e.g. bank statements.

Family members of European Economic Area nationals who are studying or financially independent must also provide evidence that the European Economic Area national and any family members hold comprehensive sickness insurance in the UK. This can include a private medical insurance policy, an EHIC card or an S1, S2 or S3 form.

**Original documents must not be sent to licensing authorities.** If the document copied is a passport, a copy of the following pages should be provided:

- (i) any page containing the holder's personal details including nationality;
- (ii) any page containing the holder's photograph;
- (iii) any page containing the holder's signature;
- (iv) any page containing the date of expiry; and
- (v) any page containing information indicating the holder has permission to enter or remain in the UK and is permitted to work.

If the document is not a passport, a copy of the whole document should be provided.

Your right to work will be checked as part of your licensing application and this could involve us checking your immigration status with the Home Office. We may otherwise share information with the Home Office. Your licence application will not be determined until you have complied with this guidance.

#### **Home Office online right to work checking service**

As an alternative to providing a copy of the documents listed above, applicants may demonstrate their right to work by allowing the licensing authority to carry out a check with the Home Office online right to work checking service.

To demonstrate their right to work via the Home Office online right to work checking service, applicants should include in this application their 9-digit share code (provided to them upon accessing the service at <https://www.gov.uk/prove-right-to-work>) which, along with the applicant's date of birth (provided within this application), will allow the licensing authority to carry out the check.

In order to establish the applicant's right to work, the check will need to indicate that the applicant is allowed to work in the United Kingdom and is not subject to a condition preventing them from doing work relating to the carrying on of a licensable activity.

An online check will not be possible in all circumstances because not all applicants will have an immigration status that can be checked online. The Home Office online right to work checking service sets out what information and/or documentation applicants will need in order to access the service. Applicants who are unable to obtain a share code from the service should submit copy documents as set out above.

DORCHESTER ROAD

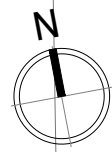

Rock Cottages

TOTAL WIDTH OF STORE 23.39 M

TOTAL DEPTH OF THE STORE 18.33M

EXISTING CROSSOVER  
PRELIM VISION SPLAY TBC BY STRYKESLIP

EXISTING CROSSOVER

LOADING AREA ONLY

**TESCO**

CAR PARK  
10 SPACES

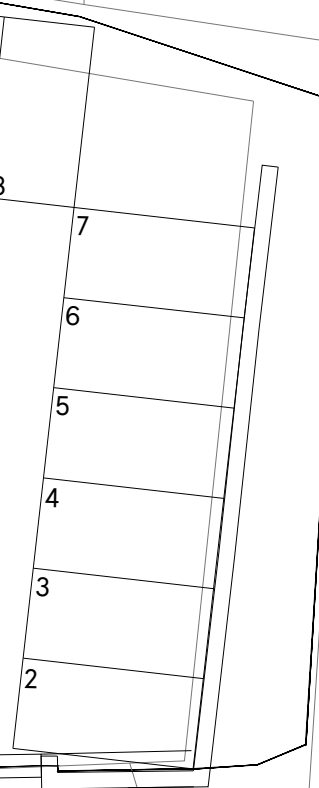

POST BOX  
LB

1:14 RAMP

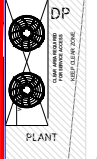

REV	DATE	AMENDMENTS
<p>ADDRESS: 680 Dorchester Road, Weymouth DT3 5LD</p>		
<p><b>FIRE DETECTION LEGEND</b></p> <ul style="list-style-type: none"> <li> SOUNDER</li> <li> VISUAL INDICATOR (BEACON)</li> <li> 6KG 27A FOAM &amp; 2KG CO2 EXTINGUISHERS</li> <li> AREA COVERED BY SMOKE DETECTION</li> <li> BREAK GLASS CALL POINT</li> </ul>		
<p>PROJECT : NORTH WEYMOUTH DORSET</p>		
<p>DESCRIPTION PROPOSED SITE BWS LICENSE LAYOUT</p>		
<p>DRAWING NO. DORSETFeaspg##BWSPLAN</p>		
<p>PHASE 1 ISSUE ##</p>		
<p>SYSTEM ID. No. DORSETFeasbg##.dwg</p>		
<p>SCALE 1:200@A3 DATE 15-FEB-2022</p>		
<p>UK PLANNING MANAGER TOM BAYLIS</p>		
<p>STORE PLANNING</p>		
<p>TESCO STORES LIMITED EXPRESS GROUP PLUS BUILDING, THE BOULEVARD, SHIRE PARK, WELWYN GARDEN CITY, HERTFORDSHIRE, AL7 1GB UK TELEPHONE - 01707 395150 THE COPYRIGHT IN THIS DRAWING IS THE PROPERTY OF TESCO STORES LIMITED ALL RIGHTS ARE RESERVED. WITHOUT THE WRITTEN CONSENT OF TESCO STORES LIMITED NO PART OF THIS DRAWING IS TO BE REPRODUCED OR TRANSMITTED IN ANY FORM OR BY ANY MEANS OR FROM ANY RETRIEVAL SYSTEM WITHOUT THE PRIOR WRITTEN LICENCE FROM THE OWNER © 2012 TESCO STORES LIMITED</p>		

LOADING AREA ONLY

TOTAL DEPTH OF THE STORE 18.33M

TOTAL WIDTH OF STORE 23.39 M

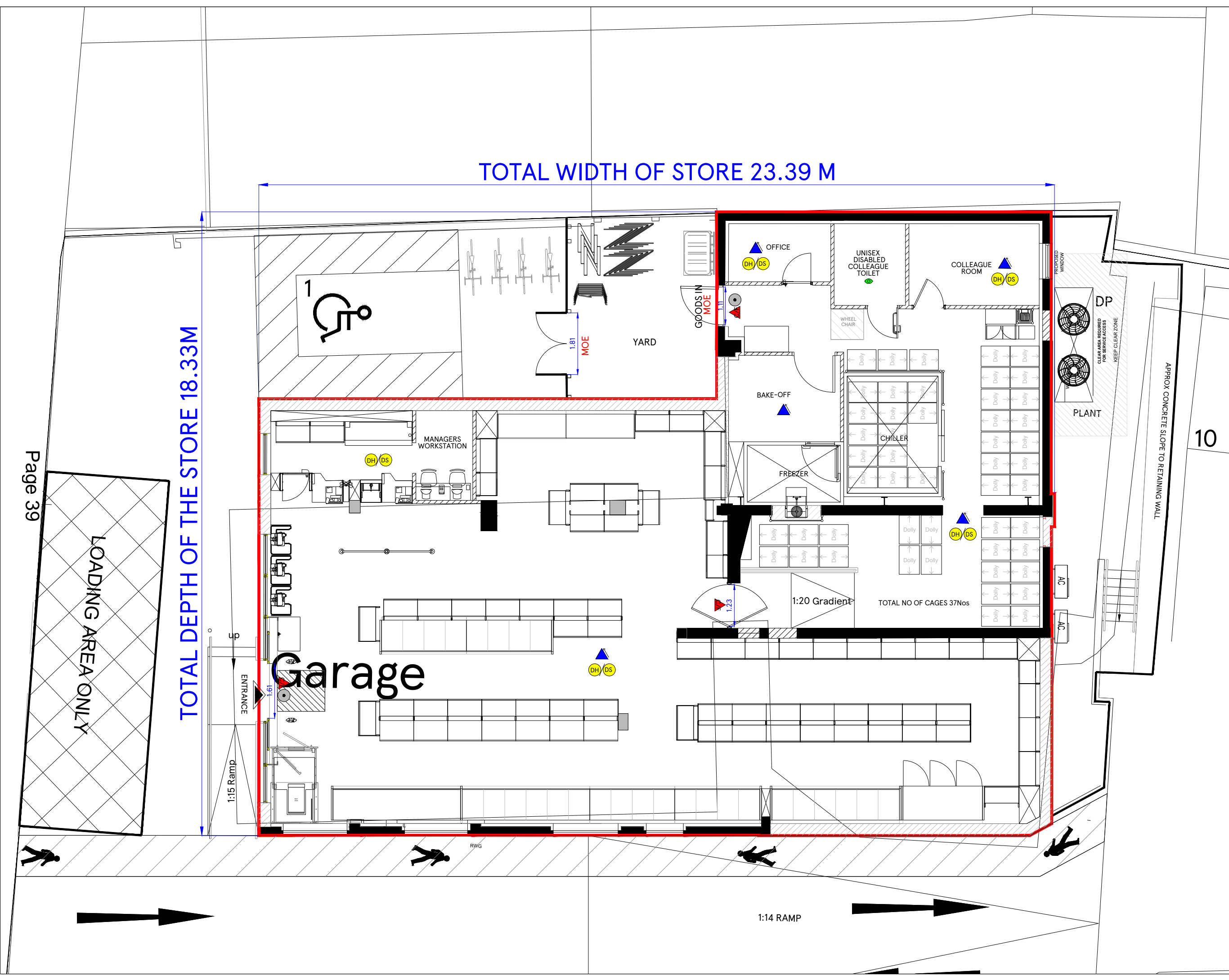

10

REV	DATE	AMENDMENTS
<p>ADDRESS: 680 Dorchester Road, Weymouth DT3 5LD</p>		
<p><b>FIRE DETECTION LEGEND</b></p> <ul style="list-style-type: none"> <li> SOUNDER</li> <li> VISUAL INDICATOR (BEACON)</li> <li> 6KG 27A FOAM &amp; 2KG CO2 EXTINGUISHERS</li> <li> AREA COVERED BY SMOKE DETECTION</li> <li> BREAK GLASS CALL POINT</li> </ul>		
<p>PROJECT : NORTH WEYMOUTH DORSET</p>		
<p>DESCRIPTION PROPOSED RETAIL BWS LICENSE LAYOUT</p>		
<p>DRAWING NO. DORSETFeasgag##BWSPLAN</p>		
<p>PHASE 1 ISSUE ##</p>		
<p>SYSTEM ID. No. DORSETFeasg##.dwg DORSETFeasg##.dwg</p>		
<p>SCALE 1:100@A3 DATE 15-FEB-2022</p>		
<p>UK PLANNING MANAGER TOM BAYLIS</p>		
<p>TESCO STORES LIMITED EXPRESS GROUP PLUS BUILDING, THE BOULEVARD, SHIRE PARK, WELWYN GARDEN CITY, HERTFORDSHIRE, AL7 1GB UK TELEPHONE: 01707 395150 THE COPYRIGHT IN THIS DRAWING IS THE PROPERTY OF TESCO STORES LIMITED. ALL RIGHTS ARE RESERVED. WITHOUT THE WRITTEN CONSENT OF TESCO STORES LIMITED, THIS DRAWING IS NOT TO BE REPRODUCED OR TRANSMITTED IN ANY FORM OR BY ANY MEANS, OR FROM ANY RETRIEVAL SYSTEM WITHOUT THE PRIOR WRITTEN LICENCE FROM THE OWNER. © TESCO STORES LIMITED</p>		

This page is intentionally left blank



## LicensingTeamB

---

**From:** [REDACTED]  
**Sent:** 26 February 2022 19:50  
**To:** LicensingTeamB  
**Subject:** Re Petition against tesco licence for dorchester road old Mazda garage building

**Follow Up Flag:** Follow up  
**Flag Status:** Flagged

**Categories:** Roy K

Good Evening ,

i am a resident in Miles Gardens opposite where you are proposing the Tesco and i strongly appose it having a license and especially for the hours your notice states !

we already have significant issues with teenagers drinking and smoking in the children's park opposite and this will make it even worse as well as the increased traffic to the area will de value our houses and this is not acceptable and i will demand compensation if this is allowed to go ahead and will sue the council if they allow this to happen.

[REDACTED]

[REDACTED]

[REDACTED]

[REDACTED]

[REDACTED]

## LicensingTeamB

---

**From:** [REDACTED]  
**Sent:** 28 February 2022 15:58  
**To:** LicensingTeamB  
**Subject:** Objection to application of a premises licence - Tesco Express 680 Dorchester Road, Weymouth, Dorset, DT3 5LD

**Categories:** Roy K

Further to the Public Notice Licensing Act 2003 in respect of the above application, I wish to strongly object on the following grounds :

This is a built up residential area with no parking to facilitate the stopping of "shoppers" to the above proposed premises.

A late night license to include the sale of alcohol is definitely not suitable to this area.

The area is occupied by mainly elderly people who will not only get their sleep disturbed but with the noise but no doubt with the less respectful section of society buying, drinking and depositing alcohol and causing a disturbance in the immediate vicinity.

There is no parking provided with this application; the road is a busy thoroughfare for residents and a bus stop is situated immediately outside the premises; this will cause shoppers to seek parking in Miles Gardens opposite. This will also cause extra driving hazards and inconvenience due to shoppers using Miles Gardens as a parking and turning area.

The area is well provided by Broadway Village Stores a few hundred yards walk away. The provision of such a store as a Tesco Express will not only impact on the immediate neighbourhood in a detrimental way but will also impact on the above village shop. We are already well provided for in the area.

I strongly object to the provision of a license to a Tesco Express at the above address for the above reasons. There is very little passing traffic apart from those who live in this residential area as the main relief road directly into Weymouth provides a direct route. Therefore, it is doubtful that a Tesco Express is required in this area or will receive much public use.

The traffic issues, parking issues and late night disturbance (as well as a danger to people living in the area from extra traffic) are all valid reasons for the Council not to agree to this license application.

I would be grateful if you could ensure that these views, which are also those of the residents of Miles Gardens, be conveyed to the appropriate local authority staff, and that the license not be granted.

With Many thanks and kind regards

[REDACTED]  
[REDACTED]

## LicensingTeamB

---

**From:** [REDACTED]  
**Sent:** 02 March 2022 16:38  
**To:** LicensingTeamB  
**Subject:** Proposed Tesco Express at 680 Dorchester Rd

**Follow Up Flag:** Follow up  
**Flag Status:** Flagged

**Categories:** Roy K

### Proposed Tesco Express Store @ 680 Dorchester Road, Weymouth

I am writing to object strongly to the proposition to develop the above store for the following reasons:

- 1 The proposed store will effectively close the nearby **Broadway Stores**. Broadway Stores serves the area very effectively and with great customer service. The store was particularly vital during the pandemic lockdown (including offering local free deliveries) but the establishment of the proposed Tesco store will take away so much of their trade that they will not survive. The proprietors of the Broadway Stores have given so much of themselves, their energies and their money to the establishment of an excellent business and do not deserve to be driven out.
- 2 The proposed extensive hours of alcohol sales in the proposed Tesco store (not to mention the proposed café facilities) will damage the trade in the nearby **Standard Public House** – a business that struggles to survive in the best of times.
- 3 **Parking** will be a problem not only for those working at the store but also for those visiting the store and for the community who live near the store. Doubtless, the site has been visited during a normal working day when there is a certain amount of on street parking available. That is not the situation at evenings and at weekends. The residents of Miles Gardens suffered from both staff and clients parking when the Mazda Garage occupied the site. Imagine the potential problems from large numbers of shoppers trying to park during the day, in the evenings, late at night and at weekends.

If the argument is that only small numbers of people will visit or work in the proposed store then the argument for having the store is not made. If the argument for the store is that there will be sufficient demand to justify it then the problem of parking is highlighted

- 4 **Nuisance**. After years of intolerable traffic, the relief road has given this part of Upwey a degree of peace and quiet. The proposed opening hours for the Tesco store (not to mention the late-night sales of alcohol and food) will lead to considerable noise and disturbance for local residents from inconsiderate parking to the banging of car doors, the revving of engines and the use of Miles Gardens for turning cars (as too frequently happens now)

Add to that the noise and disturbance generated by delivery lorries early in the morning, during the day and late in the evening and the net result is very considerable nuisance to those living anywhere near the proposed store.

In short, the siting of the proposed store in this residential area is an ill-conceived notion and should be rejected.

[REDACTED]

[REDACTED]

[REDACTED]

[REDACTED]

## LicensingTeamB

---

**From:** [REDACTED]  
**Sent:** 02 March 2022 17:20  
**To:** LicensingTeamB  
**Subject:** PUBLIC NOTICE LICENSING ACT 2003 - APPLICATION FOR A LICENCE MADE BY TESCO EXPRESS

**Follow Up Flag:** Follow up  
**Flag Status:** Flagged

**Categories:** Roy K

Dear Sirs,

### **OBJECTION TO APPLICATION FOR A LICENCE – 680 DORCHESTER ROAD, UPWEY, WEYMOUTH DT3 5LD**

My husband I are most alarmed to see that Tesco Express has made an application for a Licence to sell alcohol and other foodstuffs on the site of the former Mazda Garage at 680 Dorchester Road, Upwey, DT3 5LD.

This stretch of the Dorchester Road is now used in the main by local residents, and especially so since the construction of the new By-Pass connecting Weymouth and Dorchester. The change of use from a Garage Showroom to a Tesco Express will cause a lot of unnecessary traffic passing through the village as well as causing noise (by traffic and people) and pollution fumes in this lovely unspoilt valley.

At present the Upwey/Broadwey residents have the use of adequate shopping at Morrisons, Sainsburys, Broadwey Village Stores and the various shops at Littlemoor so the addition of a Tesco Express is certainly not needed on the Dorchester Road. There are also two public houses in Upwey – The Royal Standard, which is a stone's throw away from the proposed Tesco Express, and The Old Ship, a little further along the Dorchester Road, on the Ridgeway, both providing food and drink to the locals and holiday makers in the summer months.

We are alarmed at the request to be open for so many hours in the week particularly at such antisocial hours late at night.

It is doubtful that the proposed facilities will be used by the local residents and another concern is: where will the customers, who come from outside the Upwey/Broadwey area, park? It is likely that they will pull off the road into Miles Gardens and park in this peaceful residential cul-de-sac. The No 10 bus stop is also situated between The Royal Standard and the proposed Tesco Express and parking and turning around there will be very hazardous.

This site would be much better suited for building two or three much-needed small family houses in keeping with those along the Dorchester Road. There is no need for building on any surrounding green sites, but this is a brown site which would be perfect for such use.

Please accept this as our formal objection.

Yours faithfully



## LicensingTeamB

---

**From:** [REDACTED]  
**Sent:** 03 March 2022 12:48  
**To:** LicensingTeamB  
**Subject:** Objection to application for licence 680 Dorchester rd Upwey DT3 5LD

**Follow Up Flag:** Follow up  
**Flag Status:** Completed

**Categories:** Roy K

RE application for a licence made by Tesco Express 680 Dorchester Rd Upwey DT3 5LD

I am once again submitting an objection for proposed change of use / licence for the above property at 680 Dorchester rd where the old Mazda garage was situated.

I cannot believe the proposal for a Tesco Express on this site is even being considered given the location, limited parking, & bus top,

This is a residential area [ apart from the site next door which is no less than a rubbish dump]

There are enough shops and pubs in the area and the proposed opening times would be totally antisocial and potentially attract the wrong sort of clientele from the surrounding area.

With the shortage of first homes in Dorset why can't the land be sold for housesing.

Please accept this as a strong objection,

Yours Sincerely,

[REDACTED]

## LicensingTeamB

---

**From:** [REDACTED]  
**Sent:** 04 March 2022 00:54  
**To:** LicensingTeamB  
**Subject:** Fwd: APPLICATION FOR LICENCE - TESCO EXPRESS - 680 DORCHESTER ROAD

**Follow Up Flag:** Follow up  
**Flag Status:** Flagged

**Categories:** Roy K

----- Forwarded message -----

**From:** [REDACTED]  
**Date:** Fri, Mar 4, 2022 at 12:40 AM  
**Subject:** APPLICATION FOR LICENCE - TESCO EXPRESS - 680 DORCHESTER ROAD  
**To:** <[licensingteam@dorsetcouncil.gov.uk](mailto:licensingteam@dorsetcouncil.gov.uk)>

4 March 2022

Dear Sir/Madam

May I please raise a personal objection to the above proposed development.

The volume of traffic has increased in this area and with the coming and going from a busy supermarket will cause hold ups and potential accidents particularly during the summer months. The already ridiculous amount of traffic which uses Church Street, Stottingway Street and Elwell Street as a rat-run during commuter periods, will be exacerbated as locals will try to dodge any hold ups on the main road. It really is dangerous for any pedestrians who are brave enough to step outside their houses at these times!

We have the option to use myriad supermarkets in this area without bowing to the huge conglomerates' need to expand. For our day to day needs we are served by an excellent village store. We should support our local businesses.

Many thanks for your consideration.

[REDACTED]

[REDACTED]



Virus-free. [www.avg.com](http://www.avg.com)



## LicensingTeamB

---

**From:** [REDACTED]  
**Sent:** 05 March 2022 08:48  
**To:** LicensingTeamB  
**Subject:** Tesco express proposal

**Follow Up Flag:** Follow up  
**Flag Status:** Flagged

**Categories:** Roy K

Please note our objection to the proposed Tesco plan for the old Mazda site on Dorchester Road. Yet another attempt by a large retailer to damage a local business, namely The Broadway Store that has done so much to support the local community especially during the pandemic.

Thank you

[REDACTED]  
[REDACTED]

Sent from my iPad

**LicensingTeamB**

---

**From:** [REDACTED]  
**Sent:** 06 March 2022 15:00  
**To:** licensingteam@dorsetcouncil.gov.uk  
**Subject:** Say no to Tesco.

Dear sir/madam,

I wish to object to a license being granted for a Tesco on Dorchester Road, Upwey Weymouth. Due to the anti social behaviour this will cause in my local area amongst numerous other anyouses.

Yours Sincerely

[REDACTED]  
[REDACTED]  
[REDACTED]  
[REDACTED]  
[REDACTED]  
[REDACTED]  
[REDACTED]

## LicensingTeamB

---

**From:** [REDACTED]  
**Sent:** 06 March 2022 17:30  
**To:** LicensingTeamB  
**Subject:** Fwd: No to Tesco !

**Follow Up Flag:** Follow up  
**Flag Status:** Flagged

**Categories:** Roy K

Begin forwarded message:

**From:** [REDACTED]  
**Subject: No to Tesco !**

Good afternoon

I believe that a new Tesco is due to open on the Dorchester rd in Upwey/Broadwey. We really don't need another supermarket - we already have Tesco in Dorchester and a choice of more down on Mercier way. I moved away from the towns and city nearly 3 years ago to come to a peaceful village and use local produce where possible. We have broadwey stores already which sells more than enough groceries and additional store items. Surely this would cause anti social behaviour and additional noise which locals do not need. I love my local area and neighbours. The only thing missing in Upwey is a doctors surgery with a chemist!!

Should Tescos open, I will not shop there, I would rather walk a little further to Broadway village stores. I hope Dorset council listens to the locals and this doesn't happen.

Kind regards

[REDACTED]  
Upwey resident

## LicensingTeamB

---

**From:** [REDACTED]  
**Sent:** 06 March 2022 18:59  
**To:** LicensingTeamB  
**Subject:** Save our village

**Follow Up Flag:** Follow up  
**Flag Status:** Flagged

**Categories:** Roy K

To whom it may concern

I fear for the safety of my quite little village, due to Tesco making changes is right for our peaceful way of life.

I feel it would be inappropriate for Tesco to aloud to make changes, I have a small son I worry about if this proposal is to go forward.

There will be an increase of violence and reckless behaviour due opening hours,

I have a baby and I fear for the summer holidays as people will be consuming large amounts of alcohol and due to leaving COVID restrictions behind, it would not do to have allowing Tesco to make such changes.

Please reconsider such action from a concerned mother

Kind regards

[REDACTED]

## LicensingTeamB

---

**From:** [REDACTED]  
**Sent:** 07 March 2022 09:33  
**To:** LicensingTeamB  
**Subject:** Tesco Express 680 Dorchester Road

**Follow Up Flag:** Follow up  
**Flag Status:** Flagged

**Categories:** Roy K

I am a Senior Citizen living at Miles Gardens, my main concern would be granting a late licence of selling alcohol possibly creating more anti- social behaviour in the childrens play area.

## LicensingTeamB

---

**From:** [REDACTED]  
**Sent:** 07 March 2022 09:37  
**To:** LicensingTeamB  
**Subject:** Oppose Licence for Tesco in Upwey

**Follow Up Flag:** Follow up  
**Flag Status:** Flagged

**Categories:** Roy K

Dear Licensing Team,

I would like to oppose the licence request to sell alcohol on Dorchester Road at the site of the old Maza Garage in Upwey.

We already have an independent local shop which would be negatively impacted. The village does not need a multinational corporation shop, it would increase traffic and cause anti-social behaviour in a very peaceful and quite area.

I strongly disagree that the site should be used to sell alcohol.

Kind regards,

[REDACTED]  
[REDACTED]

## LicensingTeamB

---

**From:** [REDACTED]  
**Sent:** 07 March 2022 09:45  
**To:** LicensingTeamB  
**Subject:** Planning objection-Tesco Dorchester road

**Follow Up Flag:** Follow up  
**Flag Status:** Flagged

**Categories:** Roy K

To whom I may concern,

I would like to put in an objection to the planned development of a Tesco store on Dorchester road at the former Mazda garage site.

Upwey/broadway is a small quiet residential area with no requirement for a late night opening store. My objection is regarding a potential increase in antisocial behaviour as a direct result of the late opening and alcohol licensing. Littering and social disorder in this quiet area will negatively impact residents.

Best wishes,

[REDACTED]

## LicensingTeamB

---

**From:** [REDACTED]  
**Sent:** 07 March 2022 12:28  
**To:** LicensingTeamB  
**Subject:** Alcohol licence for tescos 680 Dorchester road Weymouth

**Follow Up Flag:** Follow up  
**Flag Status:** Flagged

**Categories:** Roy K

Please accept the following objections to the above application.

1. The villages of Upwey and Broadwey are already well served by the Village Store and two pubs for the sale of alcohol.
2. A shop open from 6am to midnight would be totally out of character for the area, certainly not required where only a minutes drive away one is in the countryside.
3. What evidence is there of a demand for alcohol after the present opening hours of the existing village store.
4. Why is it necessary to be able to sell alcohol; from 6am, the sale of alcohol for 18 hours a day can only encourage excessive drinking and indeed drunkenness in a quiet residential area which is, thankfully relatively free of trouble. Furthermore surely if people know alcohol can be obtained late this would encourage them to drive to the shop from other local areas such as Littlemoor meaning potentially more drunk drivers.

Thank you for your consideration.

Sent from [Mail](#) for Windows



## LicensingTeamB

---

**From:** [REDACTED]  
**Sent:** 07 March 2022 13:40  
**To:** LicensingTeamB  
**Subject:** Application by Tescos for liquor licence at Dorchester Rd DT3

**Follow Up Flag:** Follow up  
**Flag Status:** Flagged

**Categories:** Roy K

This concerns an application by Tescos for the sale of alcohol at premises in approximate location DT3 5NH, formerly the site of Wey Valley Mazda. As I understand it, this licence would allow Tescos to see alcohol at any hour of day or night, for consumption on or off the premises.

I OBJECT to this application.

I have been unable to find out what criteria you apply when considering such applications so some of what I say below may not be relevant.

This is a quiet residential neighbourhood as yet not affected by the outbreak of vandalism that has affected many areas in Weymouth. I therefore OBJECT to any sale of alcohol for consumption off the premises outside normal shopping hours.

As regards consumption of alcohol on the premises, there are two pubs nearby. The Royal Standard is within 100 metres the the Old Ship which has just been reopened under new management. Both serve food and operate reasonable hours - not beyond 11pm at night. I OBJECT to any sales of alcohol on the premises after 11pm and to the unneeded destructive competition Tescos would offer.

I was unaware of the planning application which must have been determined last year. I cannot find any details. However I assume it was for a 'Tesco Express'. The food sold in such places is not sufficient to provide a healthy diet. By contrast the family run Broadway Stores (a few hundred metres to the South) is a lifeline in these days in which internet food shopping is becoming less and less reliable. However, to remain financially viable, they have to sell some alcohol, cigarettes etc. Tescos would threaten this.

If the current application is rejected Tescos will modify their demands.  
How can I be best informed on what happens?

yours sincerely

[REDACTED]

## LicensingTeamB

---

**From:** [REDACTED]  
**Sent:** 07 March 2022 13:43  
**To:** LicensingTeamB  
**Subject:** Proposed Tesco store in Upwey

**Follow Up Flag:** Follow up  
**Flag Status:** Flagged

**Categories:** Roy K

Dear Licensing Team

Please may I express my objection to the granting of a proposed licence to a new Tesco store in Upwey.

I believe there will be considerable disruption around the site, simply because of the extensive proposed opening hours. This disruption would arise from traffic flow thus increasing noise and pollution in an already environmentally sensitive area.

Many thanks

[REDACTED]

--

*"What is a club in any case? Not the buildings or the directors or the people who are paid to represent it. It's not the television contracts, get-out clauses, marketing departments or executive boxes.*

*It's the noise, the passion, the feeling of belonging, the pride in your city. It's a small boy clambering up stadium steps for the very first time, gripping his father's hand, gawping at that hallowed stretch of turf beneath him and, without being able to do a thing about it, falling in love."*

Sir Bobby Robson

[REDACTED]

Dorset Council  
(Licensing)  
South Walks House  
South Walks Road  
DORCHESTER  
DT1 1UZ

[REDACTED]

DORSET COUNCIL  
04 MAR 2022  
Digital Mail Room

Tuesday March 1<sup>st</sup>, 2022

Dear Sir or Madam,

**Proposed Tesco Express Store @ 680 Dorchester Road, Weymouth**

I am writing to object strongly to the proposition to develop the above store for the following reasons:

- 1 The proposed store will effectively close the nearby **Broadway Stores**. Broadway Stores serves the area very effectively and with great customer service. The store was particularly vital during the pandemic lockdown (including offering local free deliveries) but the establishment of the proposed Tesco store will take away so much of their trade that they will not survive. The proprietors of the Broadway Stores have given so much of themselves, their energies and their money to the establishment of an excellent business and do not deserve to be driven out.
- 2 The proposed extensive hours of alcohol sales in the proposed Tesco store (not to mention the proposed café facilities) will damage the trade in the nearby **Standard Public House** – a business that struggles to survive in the best of times.
- 3 **Parking** will be a problem not only for those working at the store but also for those visiting the store and for the community who live near the store. Doubtless, the site has been visited during a normal working day when there is a certain amount of on street parking available. That is not the situation at evenings and at weekends. The residents of Miles Gardens suffered from both staff and clients parking when the Mazda Garage occupied the site. Imagine the potential problems from large numbers of shoppers trying to park during the day, in the evenings, late at night and at weekends.  
If the argument is that only small numbers of people will visit or work in the proposed store then the argument for having the store is not made. If the argument for the store is that there will be sufficient demand to justify it then the problem of parking is highlighted

- 4 **Nuisance.** After years of intolerable traffic, the relief road has given this part of Upwey a degree of peace and quiet. The proposed opening hours for the Tesco store (not to mention the late-night sales of alcohol and food) will lead to considerable noise and disturbance for local residents from inconsiderate parking to the banging of car doors, the revving of engines and the use of Miles Gardens for turning cars (as too frequently happens now)  
Add to that the noise and disturbance generated by delivery lorries early in the morning, during the day and late in the evening and the net result is very considerable nuisance to those living anywhere near the proposed store.

In short, the siting of the proposed store in this residential area is an ill-conceived notion and should be rejected.

Yours faithfully



*[Faint, illegible text, likely bleed-through from the reverse side of the page]*

DORSET COUNCIL  
08 MAR 2022  
Digital Mail Room



Licensing Office  
County Hall  
Collinton Park  
Dorchester  
Dorset, DT1 1XJ

Dear Sir

As a long term resident of Upwey I am writing to express my concern regarding any plans to grant TESCO a license in Upwey. Such a license would have an adverse effect on the trade and viability of the Village Store which is so essential to the village and the residents.

Yours faithfully

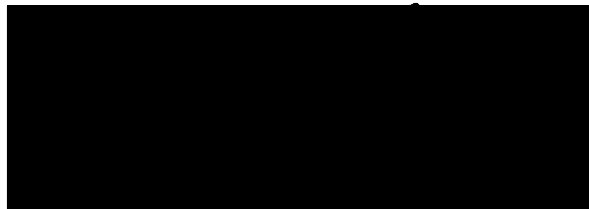

## LicensingTeamB

---

**From:** [REDACTED]  
**Sent:** 07 March 2022 15:52  
**To:** LicensingTeamB  
**Subject:** Proposed Tesco Store in Broadway/Upwey

**Follow Up Flag:** Follow up  
**Flag Status:** Flagged

**Categories:** Roy K

Dear Sir or Madam

I would like to lodge an objection to the proposal for Tesco to open a store on Dorchester Road in Broadway/Upwey. There is already ample provision of supermarkets down the road towards Weymouth and we have an adequate Village store which serves the community well. I also fear that a Tesco store will lead to more sales of alcohol leading to antisocial behaviour in the area.

Yours faithfully

[REDACTED]  
[REDACTED]

## LicensingTeamB

---

**From:** [REDACTED]  
**Sent:** 07 March 2022 17:39  
**To:** LicensingTeamB  
**Subject:** Proposed Tesco Dorchester Road, Weymouth

**Importance:** High

**Follow Up Flag:** Follow up  
**Flag Status:** Flagged

**Categories:** Roy K

### **RE: Proposed Tesco at former Mazda Garage site, Dorchester Road, Broadway, Weymouth**

We would like to object to the license application for the above proposed development.

Broadway Stores has provided adequate services to the community, especially during the COVID pandemic & although competition can sometimes be considered a good thing, in this instance it is not.

Broadway is a quiet village & providing another alcohol license could incur anti-social behaviour & vandalism for the community. Many elderly people live in this area who would feel threatened by such behaviour.

There is adequate provision for alcohol sales not only at Broadway Stores, but also within a short distance there are Morrisons, Sainsbury's, Aldi & Lidl supermarkets who all provide sufficient alcohol choice for the public.

Our village does not need another licensed outlet.

[REDACTED]  
[REDACTED]  
[REDACTED]

## LicensingTeamB

---

**From:** [REDACTED]  
**Sent:** 08 March 2022 10:44  
**To:** LicensingTeamB  
**Subject:** License to sell alcohol at proposed Tesco store at Upwey

**Follow Up Flag:** Follow up  
**Flag Status:** Flagged

**Categories:** Roy K

Broadway Village Store and Royal Standard pub already provide sales of alcohol very well in this area. A new outlet seems unnecessary and risks damaging the peaceful nature of this area. Regards, [REDACTED]





Licensing  
Dorset Council  
South Walks House  
South Walks Road  
Dorchester  
Dorset DT1 1UZ

8 March 2022

Dear Sir/Madam

**APPLICATION FOR NEW PREMISES LICENCE - TESCO EXPRESS, 680 DORCHESTER ROAD, WEYMOUTH, DORSET, DT3 5LD**

Reference:

A. Planning Decision Notice for former Mazda Showroom - P/FUL/2021/02704 Dated 7 February 2022

I write to comment on the above licence application and to register my objection.

The application is for the following:

- The sale by retail of alcohol (off the premises) on the following days: Monday - Sunday (06:00 - 00:00)
- The provision of late-night refreshment (indoors) on the following days: Monday - Sunday (23:00 - 00:00)

These operating times are in excess of all of the Tesco outlets in the Weymouth and Portland area and are deemed totally inappropriate for the small rural village community of Upwey.

It is of note that the planning approval at Reference had the following stipulation:

No deliveries shall be taken at or despatched from the site outside the hours of 08:00 to 18:00 nor at any time on Sundays, Bank or Public Holidays.

Reason: To protect nearby residential accommodation from excessive noise at night time/evening/Sundays and Bank Holidays

Arguably, the to and fro of customers is going to impact on the nearby residents as much as deliveries so restrictions should be in place in keeping with the expectations of a village community. At minimum I consider that they should be similar to those in place at the Portland Tesco namely:

Monday to Saturday	07:00	23:00
Sunday	10:00	16:00

I have no doubt that you will give this application your due consideration and hope that my input provides an indication of the strength of feeling of someone within the community which this store is allegedly wishing to serve.

Yours faithfully

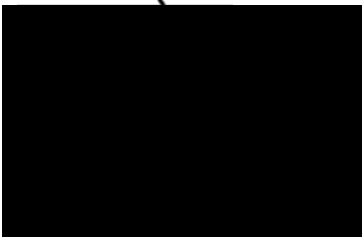

## LicensingTeamB

---

**From:** [REDACTED]  
**Sent:** 08 March 2022 15:32  
**To:** LicensingTeamB  
**Subject:** Opposition to new Tesco Express Upwey licence application .

**Follow Up Flag:** Follow up  
**Flag Status:** Flagged

**Categories:** Roy K

We wish to record our opposition to the new Tesco Express Dorchester Road ,Upwey licence to sell Alcoholic products 0600hrs - 0000hrs Monday to Sunday and the provision of in house sales 2300hrs - 0000hrs - if the Licence is granted .

We have lived on/off Dorchester Road , Upwey for over 40 years and regularly use the two pubs " The Old Ship " and " The Royal Standard " both pubs are struggling - when we first moved to Upwey ,there were 6 pubs in easy walking distance ! There were also 2 Post Offices , 2 Fuel Stations a Chemist , a Bakers ,several other individual shops and Miles nurseries - all have gone !

The Broadway Village Stores offers a range of alcoholic drinks - perhaps in the role of the traditional Off Licence - Tesco as a Multi National store with special offers and an almost " open all hours" offers totally unfair competition to the 2 pubs and store .

Both pubs and store are also centres of local social interaction and information -Tesco is a Multi national organisation and they are more interested in profit rather than the public good hence our opposition .

Please think and consider carefully and rationally your decision - to maintain and support local businesses rather than supporting the application of Tesco which could well lead to the closure of the 2 remaining pubs and put the future of the stores in jeopardy .

[REDACTED] .

## LicensingTeamB

---

**From:** [REDACTED]  
**Sent:** 08 March 2022 15:35  
**To:** LicensingTeamB  
**Subject:** Tesco Store, Upwey. License Application

**Follow Up Flag:** Follow up  
**Flag Status:** Flagged

**Categories:** Roy K

Dear Sir/ Madam

Please include my objection to the proposed application by Tesco Stores for 680, Dorchester Rd, Weymouth.

1. The application to operate a Tesco store from 06:00 to 00:00 can be expected to have negative impact on the locality with increased traffic and noise. It should be considered a public nuisance on that basis.
2. The company claims to have a "good neighbour" ethos but in the proposed location, the applicants submission will massively and adversely impact on the neighbourhood and its existing community store at Broadway.

[REDACTED]

[REDACTED]

[REDACTED]

Sent from my iPad

## LicensingTeamB

---

**From:** [REDACTED]  
**Sent:** 08 March 2022 15:47  
**To:** LicensingTeamB  
**Subject:** Licensing application

**Follow Up Flag:** Follow up  
**Flag Status:** Flagged

**Categories:** Roy K

I would like to strongly object to the licensing of the Tesco store at upwey weymouth formally the Mazda garage I think this will cause antisocial behaviour as well as a magnet for break ins we already have one licensed premises further along the road so cannot understand why we would want another one so close

Regards [REDACTED]

Sent from my iPad

## LicensingTeamB

---

**From:** [REDACTED]  
**Sent:** 09 March 2022 10:33  
**To:** LicensingTeamB  
**Subject:** Proposed Tesco

**Follow Up Flag:** Follow up  
**Flag Status:** Flagged

**Categories:** Roy K

To whom it may concern:

We would like to register our opposition for the development of the former Mazda Garage, Dorchester Road into a Tesco outlet.

We believe this would increase traffic exponentially on an already busy road. Added this to this we are concerned it would also increase the potential for antisocial behaviour in the surrounding area.

As local residents, we are already adequately served in respect of groceries, etc., with a well established and trusted village store nearby.

We do not need more supermarket giants in Weymouth. There are already far too many.

Please let us keep the charm and character of our pleasant village without this unnecessary development going ahead.

Yours sincerely

[REDACTED]  
[REDACTED]  
[REDACTED]  
[REDACTED]  
[REDACTED]

## LicensingTeamB

---

**From:** [REDACTED]  
**Sent:** 09 March 2022 11:31  
**To:** LicensingTeamB  
**Subject:** Objection to proposed TESCO store in Upwey

**Follow Up Flag:** Follow up  
**Flag Status:** Flagged

**Categories:** Roy K

To whom it may concern,

I am writing as a local resident to object to the siting of a new TESCO outlet where the Mazda garage used to be. We already have a local shop which serves us perfectly well whose business may be threatened by this and we do not like the prospect of the late night anti-social behaviour that often results in the vicinity of 24 hour unlicensed premises.

Please do not allow this major change to the social fabric of our neighbourhood and threat to a small local business to go ahead.

Yours sincerely,

[REDACTED]  
[REDACTED]

## LicensingTeamB

---

**From:** [REDACTED]  
**Sent:** 09 March 2022 11:41  
**To:** LicensingTeamB  
**Subject:** Tesco Store in Upwey

**Follow Up Flag:** Follow up  
**Flag Status:** Flagged

**Categories:** Roy K

Ref: Tesco Store at site of Former Mazda Garage

Please do not pass planning permission for this shop. We have a perfectly lovely 'open all hours' shop already and I feel that a shop like Tesco would encourage anti-social behavior. And be an eyesore in our lively village.

Many thanks

[REDACTED]

[REDACTED]

[REDACTED]

[REDACTED]

[REDACTED]

## LicensingTeamB

---

**From:** [REDACTED]  
**Sent:** 09 March 2022 17:28  
**To:** LicensingTeamB  
**Subject:** planning application for old garage Dorchester Road, Upwey.

**Follow Up Flag:** Follow up  
**Flag Status:** Flagged

**Categories:** Roy K

We wish to state our objection by Tesco PLC to an Express shop at the above location. It would severely impair our local shop which has been serving the community for many years and is unnecessary and duplicates the area in convenience shopping.



Virus-free. [www.avast.com](http://www.avast.com)



## LicensingTeamB

---

**From:** [REDACTED]  
**Sent:** 09 March 2022 18:44  
**To:** LicensingTeamB  
**Subject:** Upwey Tesco

**Follow Up Flag:** Follow up  
**Flag Status:** Flagged

**Categories:** Roy K

Say No to Upwey Tesco

[REDACTED]  
[REDACTED]  
[REDACTED]  
[REDACTED]

## LicensingTeamB

---

**From:** [REDACTED]  
**Sent:** 09 March 2022 18:44  
**To:** LicensingTeamB  
**Subject:** Opposition to new Tesco Express Upwey Licence application .

**Follow Up Flag:** Follow up  
**Flag Status:** Flagged

**Categories:** Roy K

We wish to record our joint opposition to the new Tesco Express Dorchester Road , Upwey Licence to sell Alcoholic products from 0600hrs-0000hrs Monday to Sunday and the provision of " in house " sales 2300hrs-0000hrs if the Licence is granted .

We have lived on/off Dorchester Road Upwey ,for over 40,years and regularly use the two pubs , " The Old Ship " and "The Royal Standard " , both pubs are struggling and if the Licence were granted their futures look problematic and a valuable social space and centre couldwell disappear ..When we first moved to Upwey there 6 pubs in easy walking distance !

## LicensingTeamB

---

**From:** [REDACTED]  
**Sent:** 10 March 2022 10:26  
**To:** LicensingTeamB  
**Subject:** Saying No To Tesco

**Follow Up Flag:** Follow up  
**Flag Status:** Flagged

**Categories:** Roy K

I am saying no to planned Tesco supermarket Dorchester Road due to concerns over that could increased litter in that area.

Regards

[REDACTED]

Sent from my Galaxy

## LicensingTeamB

---

**From:** [REDACTED]  
**Sent:** 11 March 2022 07:24  
**To:** LicensingTeamB  
**Subject:** Proposed Tesco on Old Mazda Garage Site in Upwey

**Follow Up Flag:** Follow up  
**Flag Status:** Flagged

**Categories:** Roy K

I am writing to express my opposition to Tesco's application for licensing hours at the old Mazda Garage site on Dorchester Road, Upwey.

This is a quiet residential area and a shop which was open from early hours until late at night would be noisy and disruptive. It would add extra and intrusive lighting. It would also draw traffic off the Relief Road into the village and this would defeat the whole point of the Relief Road to take traffic quickly around and into Weymouth.

We already have an excellent village shop and two local pubs and there is not the demand for extra availability. The area is also well served by the larger supermarkets to the South of Upwey and further down the Dorchester Road.

I am strongly against this application.

Your Sincerely,

[REDACTED]  
[REDACTED]

Sent from [Mail](#) for Windows

## LicensingTeamB

---

**From:** [REDACTED]  
**Sent:** 11 March 2022 10:30  
**To:** LicensingTeamB  
**Subject:** Proposed Tesco 680 Dorchester Road, Weymouth.

**Follow Up Flag:** Follow up  
**Flag Status:** Flagged

**Categories:** Roy K

I oppose the granting of a supermarket licence to Tesco for them to open at 680 Dorchester Road, Weymouth for the following reasons:-

The area is already well served by Broadway Village Stores, and it is not large enough to support two similar businesses.

Footfall for the previous business, a garage, was low. It will be a lot higher with Tesco as they will open a huge number of extra hours every week, and they will be doing their utmost to increase footfall.

This will significantly increase nuisance values; particularly noise, and harmful vehicle emissions caused by the extra people and vehicles. This will impact badly on houses in the area.

The area itself is primarily residential, and the premises would be better utilised as additional residential properties.

[REDACTED]

## LicensingTeamB

---

**From:** [REDACTED]  
**Sent:** 11 March 2022 12:18  
**To:** LicensingTeamB  
**Subject:** Objection for Tesco premises licence 680 Dorchester road

**Follow Up Flag:** Follow up  
**Flag Status:** Flagged

**Categories:** Roy K

[REDACTED]

Hi [REDACTED]

I am sure I have the correct e mail address. Please see my letter and send it on to the Authority.

Best Wishes,

[REDACTED]

----- Forwarded message -----

**From:** [REDACTED]  
**Date:** Fri, Mar 11, 2022 at 11:38 AM  
**Subject:** Delivery Status Notification (Failure)  
**To:** [REDACTED]

<icon.png>

### Message blocked

Your message to [licensingteam@dorsetcouncil.gov.uk](mailto:licensingteam@dorsetcouncil.gov.uk) has been blocked. See technical details below for more information.

The response from the remote server was:

550 5.4.1 Recipient address rejected: Access denied. AS(201806281) [REDACTED]

----- Forwarded message -----

From [REDACTED]

To: [licensingteam@dorsetcouncil.gov.uk](mailto:licensingteam@dorsetcouncil.gov.uk)

Cc:

Bcc:

Date: Fri, 11 Mar 2022 11:38:23 +0000

Subject: TESCO - 680 DORCHESTER ROAD LICENSE APPLICATION

Dear Sir / Madam,

I have examined this application and have the following comments :

1. There is no requirement for this type of food retail outlet in this part of north Weymouth. The area is served by the Village Shop, The Royal Standard , The Old Ship , Daniels , Fish and Chips, a Chinese takeaway, McColls and further down the Dorchester Road, Marks and Spencer.
2. Despite the bypass, Dorchester road is busy ; fast moving cars brest the hill from both sides of the dip where the proposed site is located . Any cars turning in and out will create a dangerous obstacle to this traffic , particularly as residents cars already occupy parking on both sides of Dorchester Road so visibility and space is restricted. At night this situation would be even more dangerous.
3. There is insufficient parking on site. Residents' cars fully occupy the available spaces on Dorchester Road in the evenings.
4. The Government is fighting a hard battle to reduce the huge and rising numbers of obese people in the United Kingdom. The last thing we need is another fast or processed food outlet.
5. There is a critical shortage of low cost housing in the U K and Dorset. This will get even worse as the Ukrainian crisis deepens and more refugees arrive.

I therefore strongly object to this License proposal . It should be rejected and the site used for low cost housing .

I request that you acknowledge receipt of this message.

Yours Sincerely,

[REDACTED]

## LicensingTeamB

---

**From:** [REDACTED]  
**Sent:** 12 March 2022 09:01  
**To:** LicensingTeamB  
**Subject:** Tesco - 680 Dorchester Road, Weymouth

**Categories:** Roy K

I object to the licence application by Tesco for the above address. The proposed off-licence and in store late night refreshment hours are until midnight 7 days a week. This will lead to public nuisance in the form of additional traffic and people gathering at or near the store.

Since the by-pass opened, Dorchester Road and surrounding area have been quiet in the evening. Having an off-licence and refreshment venue will draw people from outside the area. They will inevitably cause additional noise.

Please consider limiting the opening hours.

[REDACTED]  
[REDACTED]  
[REDACTED]  
[REDACTED]  
[REDACTED]



## LicensingTeamB

---

**From:** [REDACTED]  
**Sent:** 12 March 2022 10:21  
**To:** LicensingTeamB  
**Subject:** Proposed Tesco site on Dorchester Road, Upwey

**Follow Up Flag:** Follow up  
**Flag Status:** Flagged

**Categories:** Roy K

Dear Sir,

As a resident of the Dorchester Road I would like you to note my opposition to the proposed development of the old Mazda garage to become a Tesco shop. This area is well served by the Broadway Village Store and I believe you should support local business in preference to a large multi site business. In addition I feel that there could be a rise in anti-social behaviour if this proposal is approved.

Yours faithfully,

[REDACTED]

Sent from my iPad

## LicensingTeamB

---

**From:** [REDACTED]  
**Sent:** 12 March 2022 10:34  
**To:** LicensingTeamB  
**Subject:** New Tesco Stores on Dorchester Road.

**Follow Up Flag:** Follow up  
**Flag Status:** Flagged

**Categories:** Roy K

Dear sir,

As local residents in the area of the planned new Tesco Express, we wish to register our objection to the granting of a licence for alcohol sales.

Our local off-licence at Broadway Stores has been very important to the local community.

This is especially true since the new owners took over a few years ago and transformed the store. Especially during the recent lockdowns the Broadway Stores have served us well.

It cannot be right for our council to do nothing to protect the local independent trader from the might of the giant supermarket chain.

Tesco will survive without the licence,, Broadway Stores may not survive if you licence Tesco.

Please think very carefully about this matter.

Yours faithfully

[REDACTED]

## LicensingTeamB

---

**From:** [REDACTED]  
**Sent:** 14 March 2022 09:12  
**To:** LicensingTeamB  
**Subject:** Tesco Licensing Application. 680, Dorchester Road, Weymouth, Dorset, DT3 5LD

**Follow Up Flag:** Follow up  
**Flag Status:** Flagged

**Categories:** Roy K

Dear Licensing Team

The Upwey Society did not object to the Planning Application for change of use for the same reasons that the Planning Officer laid out in his decision.

In addition the Society do not object to the principle of this license for the sale by retail of alcohol being granted, we assume it is necessary for any small store of this type.

However we do object, on the grounds of Prevention of public nuisance, firstly to the hours that the applicant has proposed and secondly we completely object to the provision of late night refreshment (indoors) between the hours of 23.00-00.00.

Our objection is supported by the following:

1) The 6 closest Tesco Express stores all close by 11pm at the latest. Most of these are in more urban areas than this site, therefore it is completely unnecessary for these hours to be allowed. Those Tesco Express stores are Lodmoor, Wyke Regis, Lanehouse, Weymouth, Lytchett Matravers and Lyme Regis.

2) In granting the application for change of use ([Planning application: P/FUL/2021/02704 - dorsetforyou.com \(dorsetcouncil.gov.uk\)](https://planning.application: P/FUL/2021/02704 - dorsetforyou.com (dorsetcouncil.gov.uk))), the planning officer recommended, "No deliveries shall be taken at or dispatched from the site outside the hours of 08:00 to 18:00 nor at any time on Sundays, Bank or Public Holidays.

Reason: To protect nearby residential accommodation from excessive noise at night-time/evening/Sundays and Bank Holidays".

This planning condition, recognised the sites location in the heart of a small, quiet, residential village and the importance of reducing the noise and hence public nuisance.

The companies boiler plate response to compliance in this area states "The company has a "good neighbour" ethos which seeks to ensure that the premises plays an active part in the local community", while welcome, is plainly not enough protection for the village from public nuisance caused by this highly unusual (for Upwey) late night activity.

3) Having consulted a number of local residents the Society agrees with them that there is no community need for the late night extension, either from the local community, or by the wider area. The area is well served by late night refreshments for those that wish to travel or delivery services for those that don't and the need in a small residential village has not been demonstrated.

The Society requests that the Committee only approves the sale of alcohol license until 22.00 and does not approve, on any night, the provision of late night refreshment.

Please feel free to contact us if you would like any further information when considering this application.

Kind Regards



## LicensingTeamB

---

**From:** [REDACTED]  
**Sent:** 14 March 2022 10:09  
**To:** LicensingTeamB  
**Subject:** Proposed Tesco store, Dorchester Road, Upwey

**Follow Up Flag:** Follow up  
**Flag Status:** Flagged

**Categories:** Roy K

Dear Sir,

I would like to advise you of my objection to this proposal.

Upwey is well served by the existing Village store which is run by a local couple and serves as a hub for local activities. I believe you should support local businesses and help them thrive. A store owned by a business like Tesco would not do this.

It is also possible that there would be an increase in anti-social behaviour if this development proceeds due to the extended opening hours and the proximity to another area with well known problems in this respect.

Yours faithfully,

[REDACTED]

Sent from my iPad

## LicensingTeamB

---

**From:** [REDACTED]  
**Sent:** 11 March 2022 10:44  
**To:** LicensingTeamB  
**Subject:** Proposed Tesco on old Mazda Garage Site

**Follow Up Flag:** Follow up  
**Flag Status:** Flagged

**Categories:** Roy K

FAO the Licensing Team,

I am a resident in Broadway and I am writing to express my strong opposition to Tesco's application for licensing hours at the old Mazda Garage site on Dorchester Road, Upwey.

I do not believe this development is needed for several reasons

- Broadway and Upwey are already well served by an excellent village store on the Dorchester Road which has been built up over the last couple of years by the owners Kevin and Nisha. It serves the community well.
- The M&S shop at the BP garage also on the Dorchester Road provides further opportunity for customers.
- Several major supermarkets are within a short drive or bus ride from Broadway and Upwey.
- If none of the above were available locally the development would make more sense. As it stands it is completely unnecessary.
- If the development goes ahead more traffic will leave the relief road to drive down the Dorchester Road adding to noise and traffic volume late into the evening, which is also completely unnecessary.

I object strongly to the development

[REDACTED]

Sent from [Mail](#) for Windows

## LicensingTeamB

---

**From:** [REDACTED]  
**Sent:** 14 March 2022 15:23  
**To:** LicensingTeamB  
**Subject:** Licensing application for Tesco at the old Mazda Garage - Broadway.

**Follow Up Flag:** Follow up  
**Flag Status:** Flagged

**Categories:** Roy K

Dear Sir

I write on behalf of myself and my wife [REDACTED] both long standing residents of Upwey Village. Our concern over the proposed Tescos at the site of the old Mazda garage at Broadway is based on the impact of a late night license to sell alcohol and hot food. This will be unique in the area and become a draw for potential anti-social behaviour locally and a draw from surrounding areas (adjacent area stores close in the early evening for precisely this reason). In addition, this quiet residential area will be interrupted by delivery vehicles at indeterminate hours creating noise and disruption. There is no way of containing either issue to the immediate vicinity of the proposed store so the knock-on effects are equally concerning.

I do not object to the increase in retail activity or opportunity in the area, but consideration must be given to the potential disruption to village life and the peaceful enjoyment that residents can currently rely on. If the store is to go ahead then the protection for residents is paramount. I hope that the licensing authority will take a balanced view of what is appropriate for this area and constrain the extent of the licensing and permitted delivery times.

Kind regards

[REDACTED]

[REDACTED]

[REDACTED]

[REDACTED]

Licensing Office  
Dorset Council  
County Hall  
Collington Park  
Dorchester  
DT1 1XJ

11<sup>th</sup> March 2022

Reference: the future of Broadway Village Stores

Dear Sir or Madam,

It has recently come to our attention, that Tesco are planning to open a store on the site of the former Mazda garage, on Dorchester Road, Upwey.

To us, as residents of Upwey for the last 24 years, this is most alarming and unwelcome news. We are extremely concerned about the adverse effect this store would have on the business of our village shop, Broadway Village Stores.

Since taking over the stores, [REDACTED] ([REDACTED]) have worked extremely hard to make a success of their business.

It is more than just a shop, it is the hub and centre of the village, and nothing is too much trouble for [REDACTED] when it comes to the needs of his customers.

The thought that such a delightful family could be driven out of business by the arrival of yet another supermarket is unbearable, and unthinkable.

There is also an alarming concern over the prospect of anti-social behaviour which would be likely to arise, should the Tesco store be allowed to open.

The late opening hours, and the sale of alcohol long after other licensed premises have closed, is sure to attract late-night drinkers to this pretty and peaceful village.

There is already a Tesco Express at Lodmoor Hill, as well as Sainsbury's, Morrisons, Aldi and Lidl a short distance from the village, not to mention the numerous supermarkets in Weymouth and Dorchester.

We do not need or want this Tesco in Upwey.

We strongly object to, and oppose the opening of this Tesco store, and ask that you do not allow this development to take place.

Thank you.

Yours sincerely,

[REDACTED]



## LicensingTeamB

---

**From:** [REDACTED]  
**Sent:** 15 March 2022 14:30  
**To:** LicensingTeamB  
**Subject:** Tesco application for out of hours sale of alcohol and food

**Categories:** Roy K

I understand Tesco have applied for an out of hours sale of alcohol and the sale of fast food at the old Mazda garage in Upwey, Weymouth.

I would like to strongly object to this on the grounds of noise, litter and anti social behaviour that will arise on the granting of this license.

Upwey Village is a very quiet residential area and is served very adequately by a very good village store.

We have had no problems with late night noise or disruption and would like to keep it that way. I have young grandchildren living very close to this proposed outlet and as a lifelong resident of this lovely village I would like to ask the licensing team to refuse this application .

[REDACTED]

## LicensingTeamB

---

**From:** [REDACTED]  
**Sent:** 15 March 2022 17:06  
**To:** LicensingTeamB  
**Subject:** Tesco express Upwey

**Follow Up Flag:** Follow up  
**Flag Status:** Flagged

**Categories:** Roy K

Dear Sirs, With regard to the above licensing application, as a resident of Miles Gardens, my wife and I wish to object , as we feel it will lead to extra noise late at night , as well as problems with car parking.

Yours sincerely

[REDACTED]

[REDACTED]

## LicensingTeamB

---

**From:** [REDACTED]  
**Sent:** 15 March 2022 21:33  
**To:** LicensingTeamB  
**Subject:** license at 608 Dorchester rd.

**Categories:** Roy K

I would like to strongly object to the application by Tesco for a license to sale alcohol and late night snacks at 608 Dorchester road.  
In this quiet part of our village it will only lead to increased traffic , antisocial behaviour and litter, we already have a 24 hour garage nearby which covers all these needs.

[REDACTED]  
[REDACTED]  
[REDACTED]  
[REDACTED]

## LicensingTeamB

---

**From:** [REDACTED]  
**Sent:** 16 March 2022 15:25  
**To:** LicensingTeamB  
**Subject:** Say no to Tesco

**Categories:** Roy K

I would like to oppose Tesco's application to start a retail outlet in Upwey. We have an excellent shop in Broadway Village Stores. This is an ideal shop for local people and there are other supermarkets within easy driving distance. I do not believe there is enough call for another outlet.

[REDACTED]

## LicensingTeamB

---

**From:** [REDACTED]  
**Sent:** 17 March 2022 18:56  
**To:** LicensingTeamB  
**Subject:** 680 Dorchester Road

**Categories:** Roy K

I am writing to express my unease about the proposed licence for Tesco's to sell take-away alcohol until midnight, at the former Mazda garage site. It doesn't seem appropriate in a residential area, given the increased late-night noise and traffic it would generate in what is now a quiet street.

[REDACTED]

## LicensingTeamB

---

**From:** [REDACTED]  
**Sent:** 19 March 2022 11:50  
**To:** LicensingTeamB  
**Subject:** License application at 680 Dorchester Road Weymouth

**Follow Up Flag:** Follow up  
**Flag Status:** Flagged

**Categories:** Roy K

Dear sir/ madam

With reference to the above application on behalf of Tesco. I would like object to the proposed application on the ground of public safety and nuisance( anti social behaviour) namely that the proposed site is in residential area in an out of town location. A store in this location would defeat the object of the relief road in lessening traffic along this part of Dorchester Road and retail outlet selling alcohol would increase the likelihood of anti social behaviour due to long opening hours. With the increase in traffic to access the store this would turn this area into a major traffic flow area with traffic calming measures already in place it could cause a lot of congestion with deliveries and customers.

We do not need a supermarket in this area this has been proved over the years by the loss of a Coop store at Broadway and the loss of Somerfield at Littlemoor shopping centre. Maybe the new development at Littlmoor would be a better option.

Yours. [REDACTED]  
[REDACTED]  
[REDACTED]  
[REDACTED]

Sent from my iPad

Dear

Responsible premises licence Granting officer/Committee,

**OBJECTION TO APPLICATION FOR A PREMISES LICENCE.**

680 Dorchester road, upwey, Weymouth, DT3 5LD

My husband I are most alarmed to see that Tesco express has made an application for a premises licence to sell alcohol on the premises at 680 Dorchester road, upwey, Weymouth, DT3 5LD.

As a resident near by these designated premises I just wanted to raise my concern and wanted to let you know that what are the consequences that we will face if the premises licence granted for Tesco stores limited therefore am OBJECTING for the premises licence.

1. Anti social behaviour-

as am sure you aware about this area it's a very small quite village, after 6.30 pm its looks like a ghost village no many people on the road, most of the residents are here very old people including my parents, now they live here with very quite peace life, if the Tesco express open as you aware the licensing time and opening morning 6am till midnight, so what's really happen late night drinkers come round buy alcohol and drinking in the car park making unnecessary disturbance around the area such as shouting, screaming, breaking cars windows ,throwing bottle to the road, breaking bus stop glasses etc...., specially right cross the road there is a small park in the miles gardens ,youngsters already making mess up there, if there is a problem create we need extra police presence in the area, which is cost more money and time for the police department as well as council and tax payers, currently no many shop around here not open late therefore as you see crime rate in this area very very low, whoever wants to buy more their needs after the local shop close they flooding to Weymouth town centre that's why there is a lots of anti social problem creating by trouble makers, we don't really wants to create the problem around here in the village.

2. Vandalism-

Another Effect vandalism as you aware last year there was crime spree around the village, Broadway village stores, Dorset vehicle rental; castle veterinary surgery all was broken over night, we don't really know where is this trouble makers come from also broadway village stores been attacked with a knife robber, the thug been jailed now, and we are living on the main road you may not know after 10pm there is lots of youngsters are doing car racing on the Dorchester road, so we don't really wants encourage more youngsters to come round this area and having collision on the public property, creating problem or crash and die.

3. Give us Peace of life-

We are kindly asking from our council as all we are tax payers, all of you are doing most important roll and the very responsible job for the council and the county and of course our country, kindly please think twice before you making decision to approve premises licence for any super market specially for Tesco, at the moment there is no one starve to death in upwey or broadway or around the area, as you see where ever you go they opened bunch of super markets specially

tesco, sainsbury's, co-op, I DO KNOW VERY WELL THEY PAYING £24000 RATES BUT COST MORE MONEY FOR COUNCIL TO PROTECT THEIR BUSINESS, they invading everywhere specially very rural villages and DESTROY the places, their only aim is making money not to think about the peace of life, [REDACTED] I would kindly ask for who handling the particular case must be a ROLE MODELS FOR OTHER DEPARTMENTS AND STOP THESE LICENCE FOREVER AND PROTECT THE VILLAGES AS WELL AS PEOPLE IN THE VILLAGE,ITS YOUR GREAT RESPOSIBILITY TOO,AS A COUNCIL WORKERS KNOWINGLY OR UNKNOWINGLY YOU MAY MADE MISTAKES IN THE PAST BUT IM PRETTY SURE THIS PARTICULAR MATTER YOU WON'T MAKE MISTAKE AGAIN, PLEASE... PLEASE... SAY NO TO TESCO AND PLESE DON'T LET THE CAPITALISM WIN ANY WHERE IN OUR COUNTY, KINDLY PLEASE SAVE OUR BEAUTIFUL VILLAGE, OTHERWISE IN FEW YEARS TIME WE ARE END UP IN DORCHESTER MUSEUM TO SEE HOW IS OUR VILLAGES ARE LOOKS LIKE, PLEASE SAVE OUR VILLAGE AND THE PEOPLE AROUND THE VILLAGE AND LET THE PEOPLE TO GET GOOD TRUST WITH COUNCIL,PEOPLE LIVE AROUND HERE VERY FAITH ON DORSET COUNCIL SO PLEASE DON'T LET US TO GET DISSAPOINTEED "YES WE CAN"WE ARE STRONLY WORK TOGETHER TO SAVE ALL THE VILLAGES PUT FULL STOPS FOR UNNESSARY SUPERMARKETS GROW. PLEASE RESPECT PEOPLE VOICE.

PLEASE ACCEPT THIS IS AS OUR FORMAL OBJECTION.

NOTE-as am very low immunity person I may not to come to face to face meeting, if anything please write to my address or my mail address am willing to reply as soon as I can. Many Thanks.

Yours faithfully

[REDACTED]  
[REDACTED]  
[REDACTED]  
[REDACTED]  
[REDACTED]



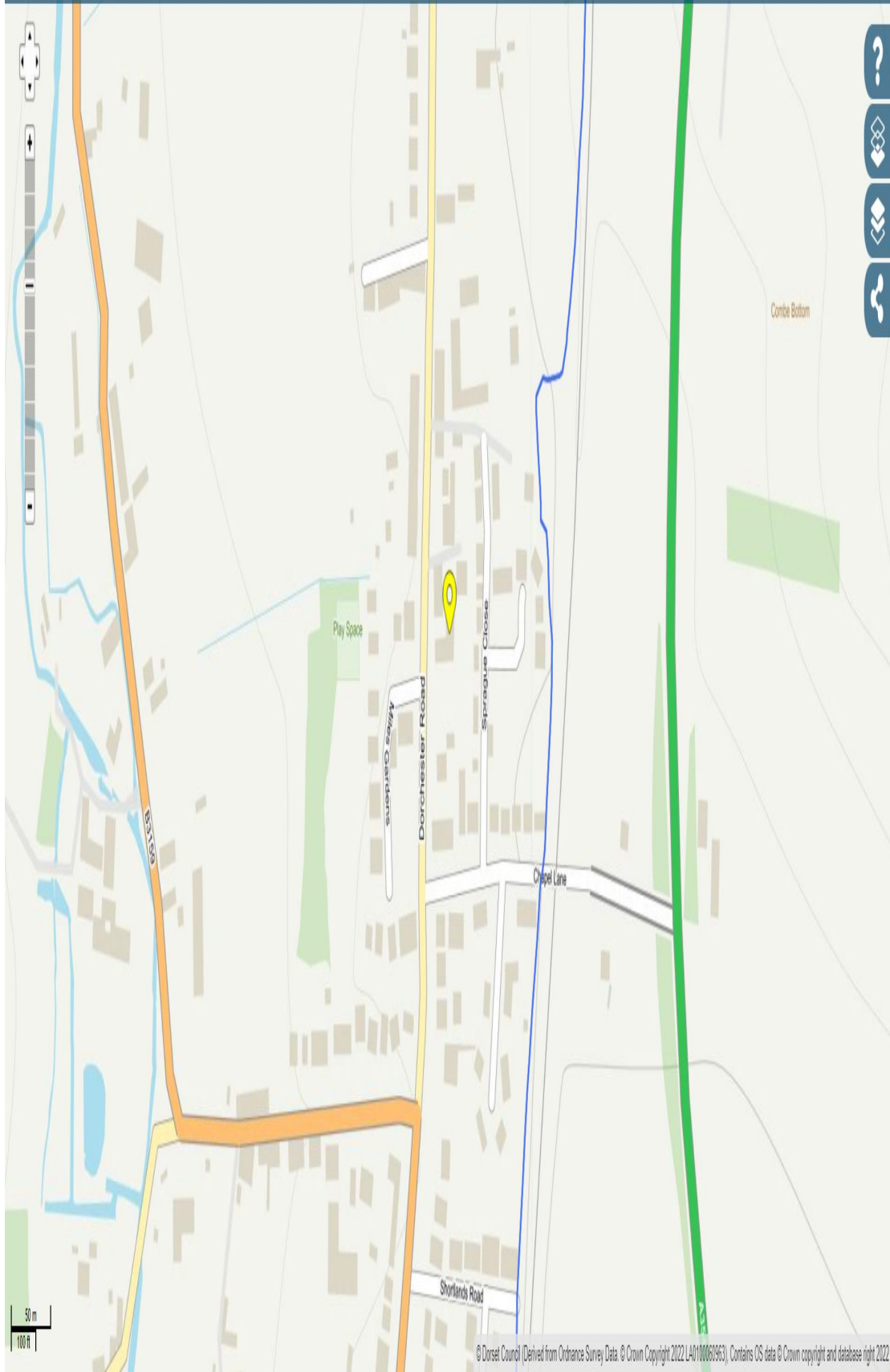

This page is intentionally left blank